

TO RUDRAPRAYAG

MANA

BR-9

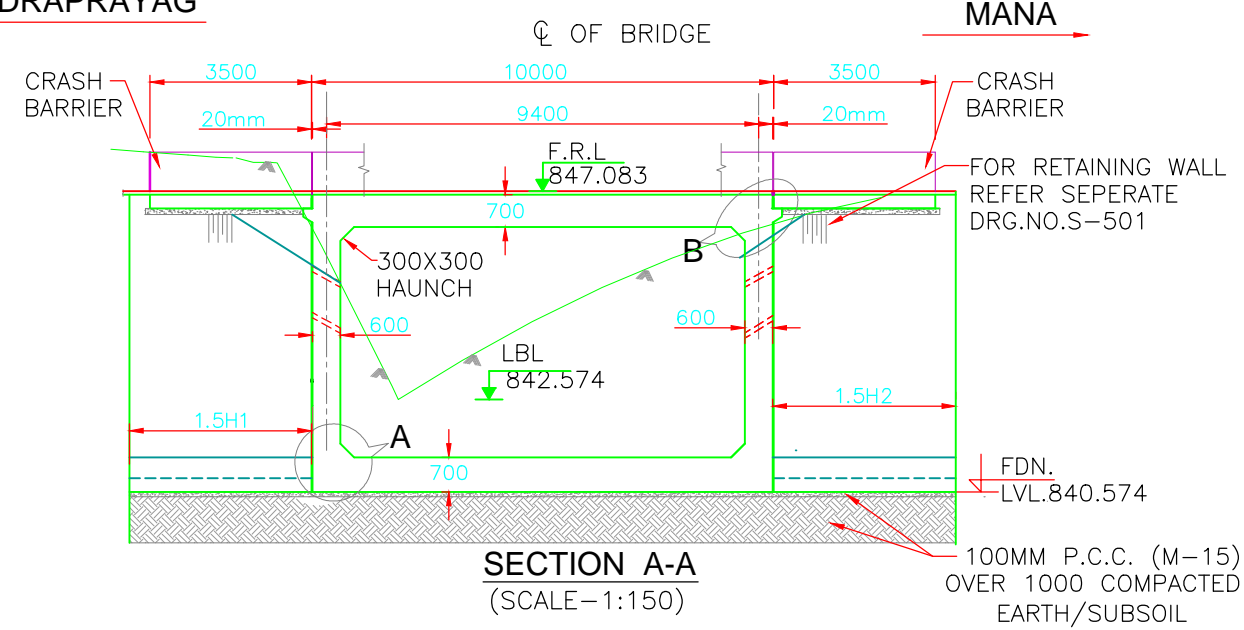

FORMATION LEVEL	847.083	847.083	847.083
GROUND LEVEL	845.703	844.37	846.292
CHAINAGE (M.)	401+987	401+992	401+997

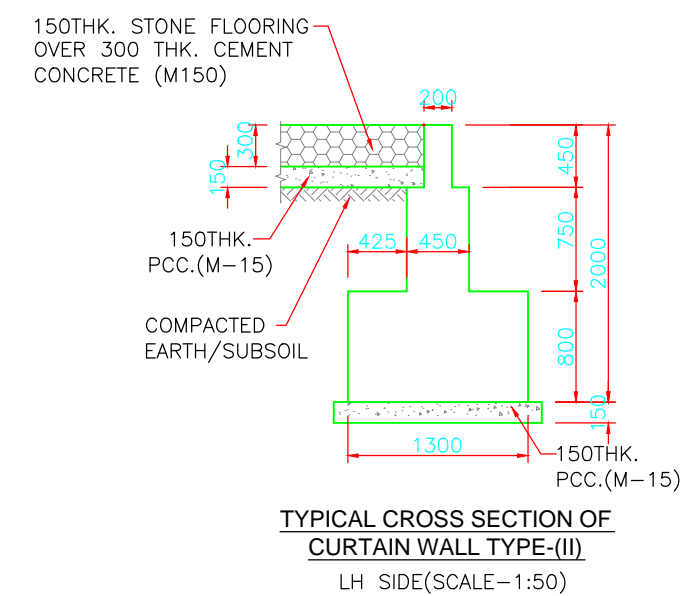
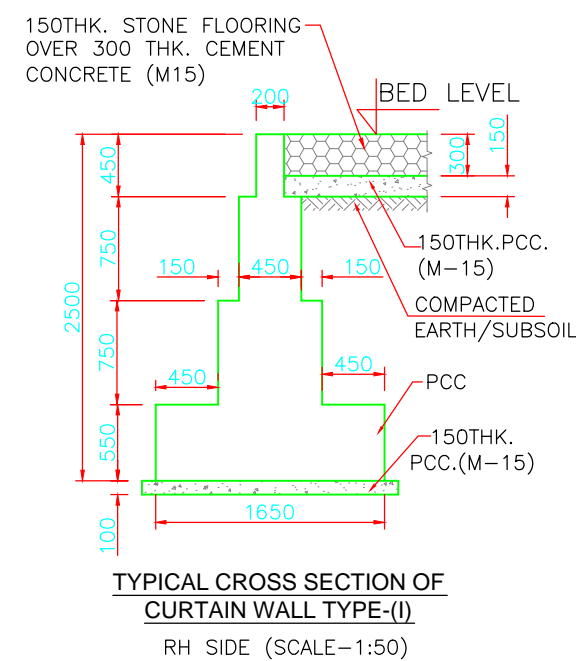
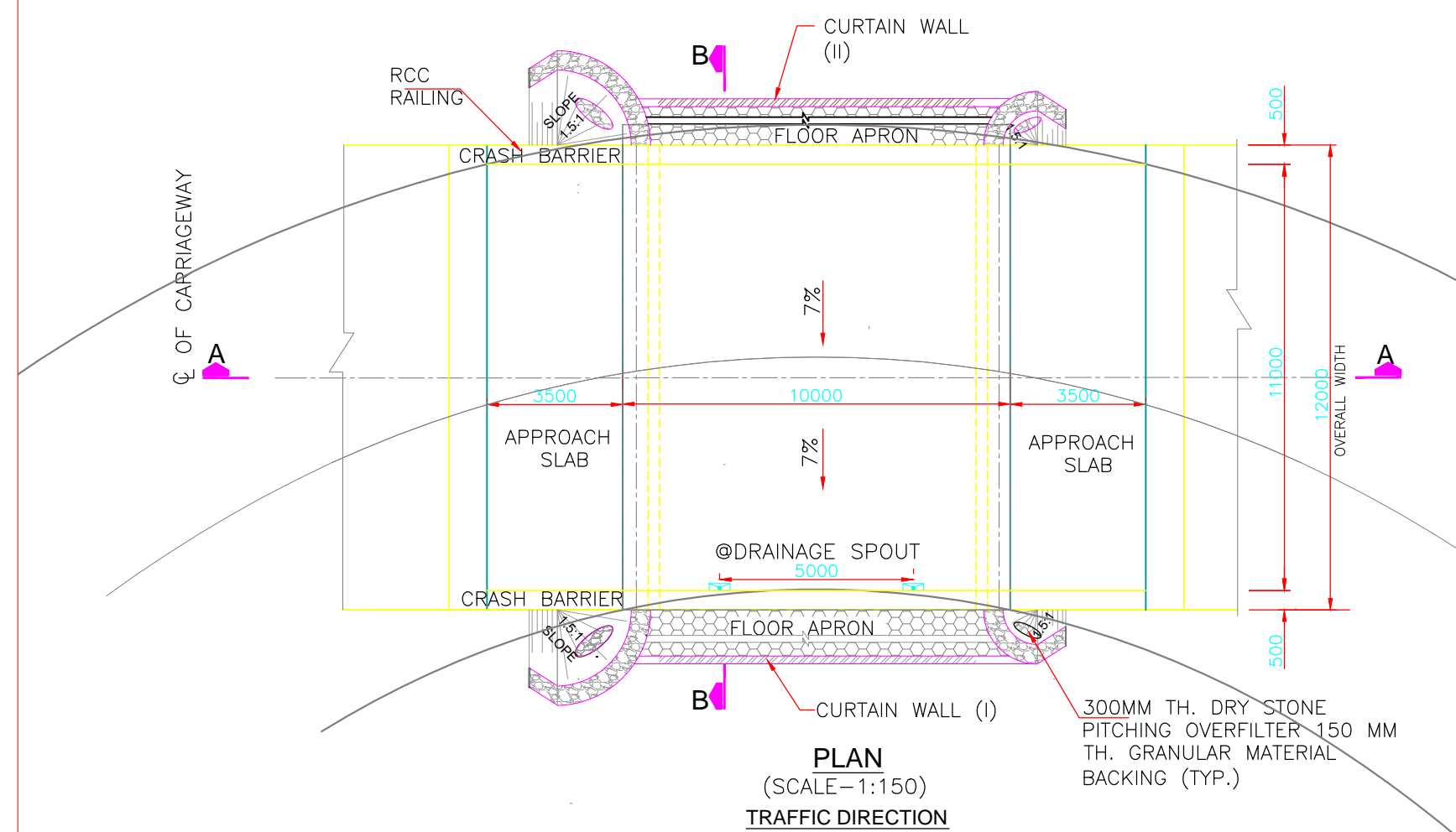
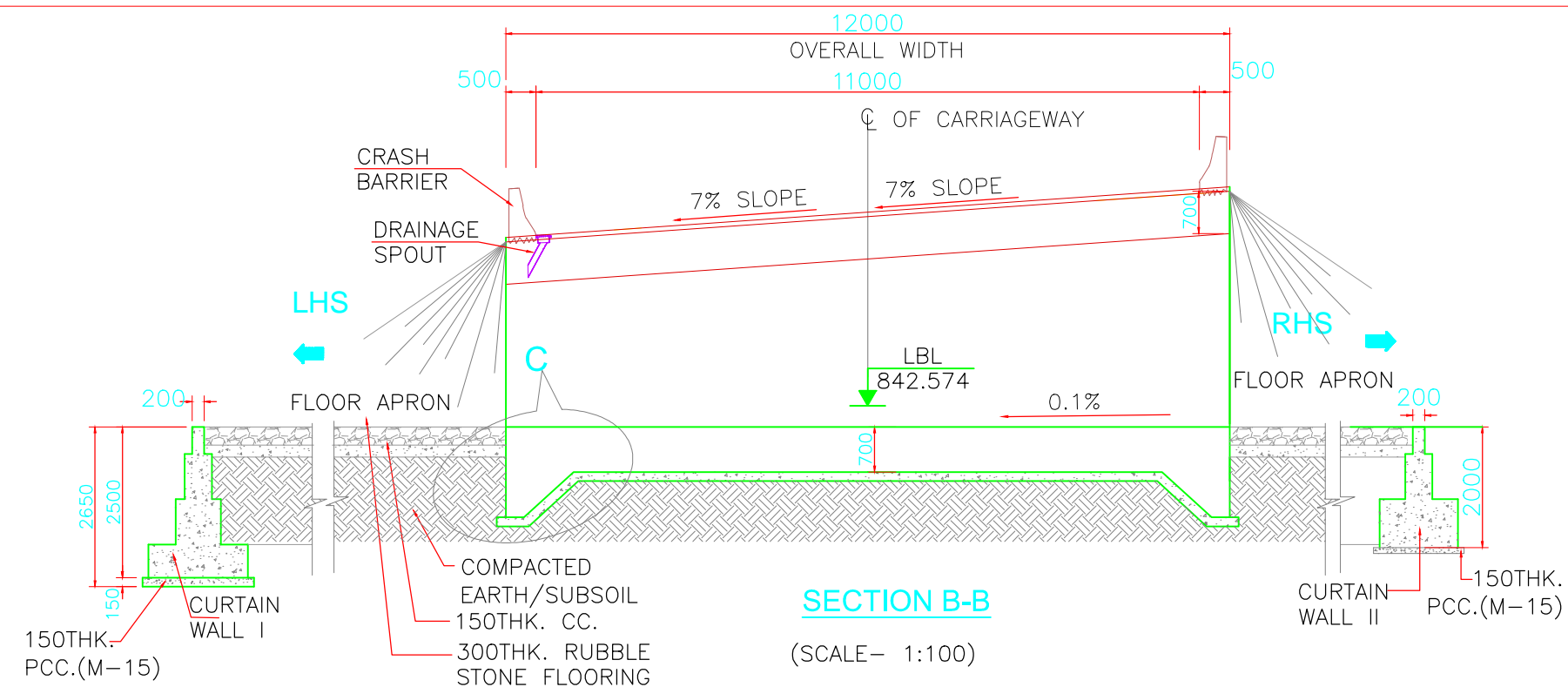

NOTES :-

- ALL DIMENSIONS ARE IN MILLIMETERS UNLESS OTHERWISE MENTIONED. ONLY WRITTEN DIMENSIONS SHALL FOLLOWED.
- THE ACTUAL BASE PRESSURE AS PER THE DESIGN 63.12 KN/SQM. THE SHOULD BE ASCERTAINED AT SITE BEFORE EXECUTION.
- THIS DRAWING SHALL BE READ IN CONJUNCTION WITH ALL OTHER DRAWINGS.
- GRADE OF CONCRETE SHALL BE AS FOLLOWS :-
P.C.C. LEVELING COURSE M15
BOX STRUCTURE M35
CRASH BARRIER M40
APPROACH SLAB M30
CURTAIN WALL M15
RETAINING/WING WALLS M35
- GRADE OF STEEL- Fe 500 CONFORMING TO IS: 1786-1985
- 75MM THK C.C WEARING COURSE SHALL BE PROVIDED AS PER SECTION 500 OF MORTH SPECIFICATIONS.
- THE SELECTED EARTH FILL BEHIND ABUTMENT SHALL HAVE FOLLOWING PROPERTIES WHICH HAVE BEEN ASSUMED FOR DESIGN OF ABUTMENTS & ABUTMENT
C1 B85HCBZ 1' Ssz[1' 5', 1' 5']
- (i) 40mm top slab
(ii) 75mm bottom slab
(iii) 40mm side wall
- IT MAY BE ENSURED THAT MINIMUM EMBEDMENT OF FOUNDATION IS 1.5M IN SOFT ROCK OR 0.6M IN HARD ROCK AS PER PROVISION OF OR IRC 78.
- ALL DIMENSIONS ARE TENTATIVE SUBJECT TO CHANGE DURING THE DETAILED DESIGN.

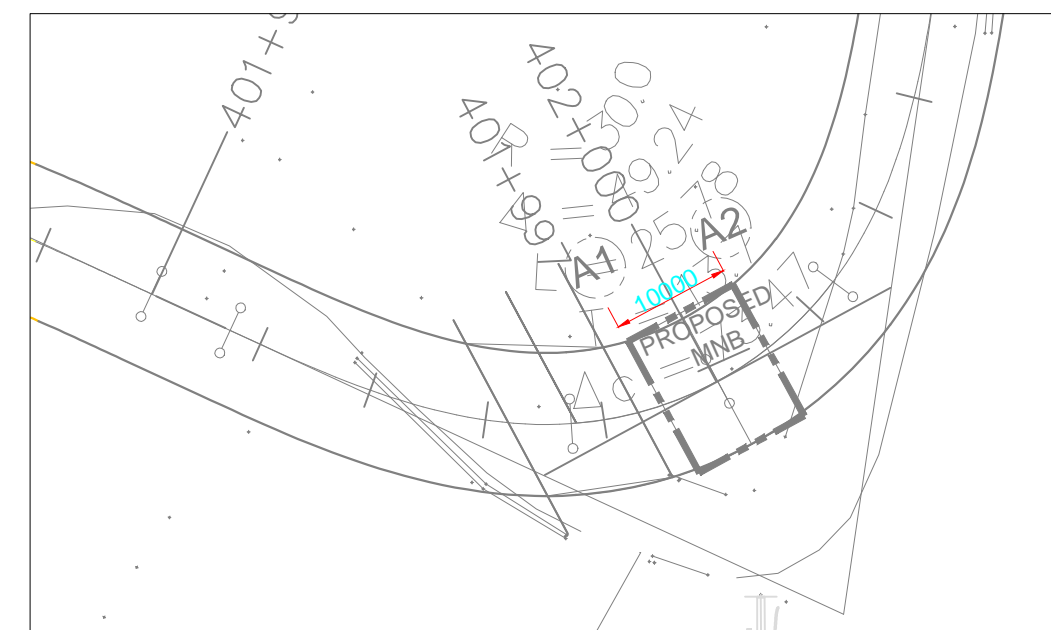
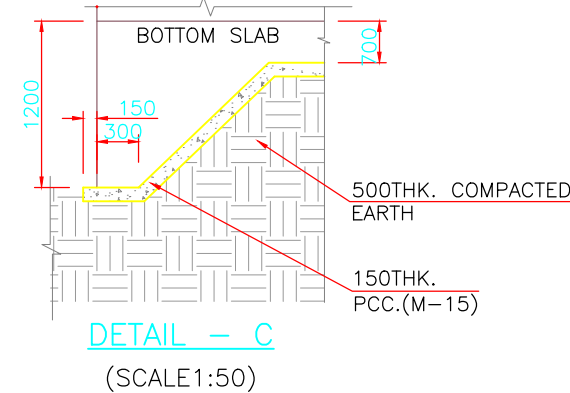
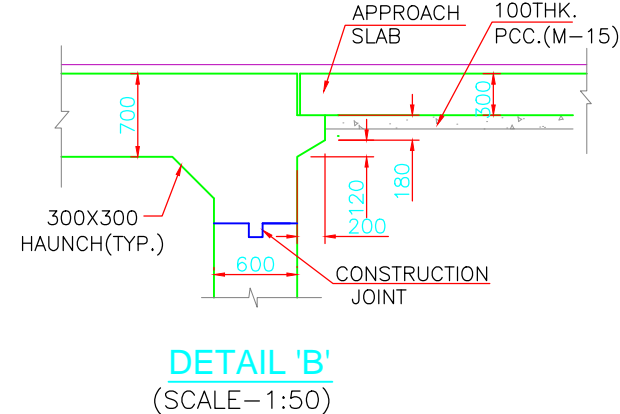
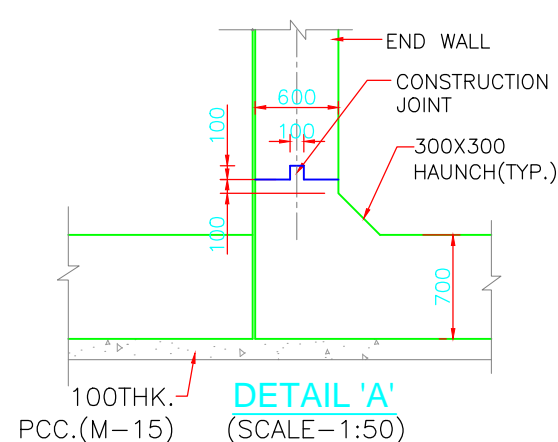

KEY PLAN

FOR PLANNING	<input type="radio"/>
FOR APPROVAL	<input checked="" type="radio"/>
FOR CONSTRUCTION	<input type="radio"/>
AS BUILT	<input type="radio"/>

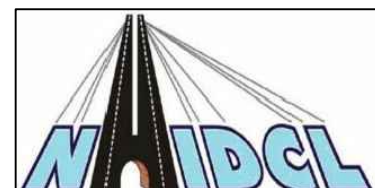

National Highways and Infrastructure
Development Corporation

PROJECT TITLE :-

CONSTRUCTION & UPGRADATION OF EXISTING ROAD TO 2-LANE WITH PAVED SHOULDERS FROM KM 399.000 TO KM 430.000 OF KARANPRAYAG TO CHAMOLI (EXCLUDING KM 420.250 TO KM 420.500 AND KM 423.300 TO KM 423.650) OF NH-07 UNDER CHARDHAM PARIYOJNA ON EPC BASICS IN THE STATE OF UTTARAKHAND (PKG-II)

REV	DATE	DESCRIPTION	SIGN

TITLE :-

GENERAL ARRANGEMENT DRAWING FOR
SOLID SLAB 10M AT CH.401+992 BOX CULVERT

DWG. NO. NHIDCL /NH-07 /MNB/ CH.401+992.10M.S-101

DRN:-	DGN:-	CHK:-	DATE:-	SCALE:-	SHEET SIZE
ALI	P.V.M	V.P.S	JAN 2018	AS SHOWN	SHEET NO:- A2 01 OF 01

NOTES :-

1. ALL DIMENSIONS ARE IN MILLIMETERS UNLESS OTHERWISE MENTIONED. ONLY WRITTEN DIMENSIONS SHALL FOLLOWED.
2. THE ACTUAL BASE PRESSURE AS PER THE DESIGN 63.12 KN/SQM. THE SHOULD BE ASCERTAINED AT SITE BEFORE EXECUTION.
3. THIS DRAWING SHALL BE READ IN CONJUNCTION WITH ALL OTHER DRAWINGS.
4. GRADE OF CONCRETE SHALL BE AS FOLLOWS :-
P.C.C. LEVELING COURSE M15
BOX STRUCTURE M35
CRASH BARRIER M40
APPROACH SLAB M30
CURTAIN WALL M15
RETAINING/WING WALLS M35
5. GRADE OF STEEL- Fe 500 CONFORMING TO IS: 1786-1985
6. 75MM THK C.C WEARING COURSE SHALL BE PROVIDED AS PER SECTION 500 OF MORTH SPECIFICATIONS.
7. THE SELECTED EARTH FILL BEHIND ABUTMENT SHALL HAVE FOLLOWING PROPERTIES WHICH HAVE BEEN ASSUMED FOR DESIGN OF ABUTMENTS & ABUTMENT :-
CI B85HCB2 1' S&2[1' %, 110
8. (i) 40mm top slab
(ii) 75mm bottom slab
(iii) 40mm side wall
9. 100 DIA. WEEP HOLES ARE TO BE PROVIDED @1000 C/C IN STAGGERED MANNER (BOTH HORIZONTALLY & VERTICALLY) IN 1:20 SLOPE (TYP).
10. IT MAY BE ENSURED THAT MINIMUM EMBEDMENT OF FOUNDATION IS 1.5M IN SOFT ROCK OR 0.8M IN HARD ROCK AS PER PROVISION OF OR IRC 78
11. ALL DIMENSIONS ARE TENTATIVE SUBJECT TO CHANGE DURING THE DETAILED DESIGN.

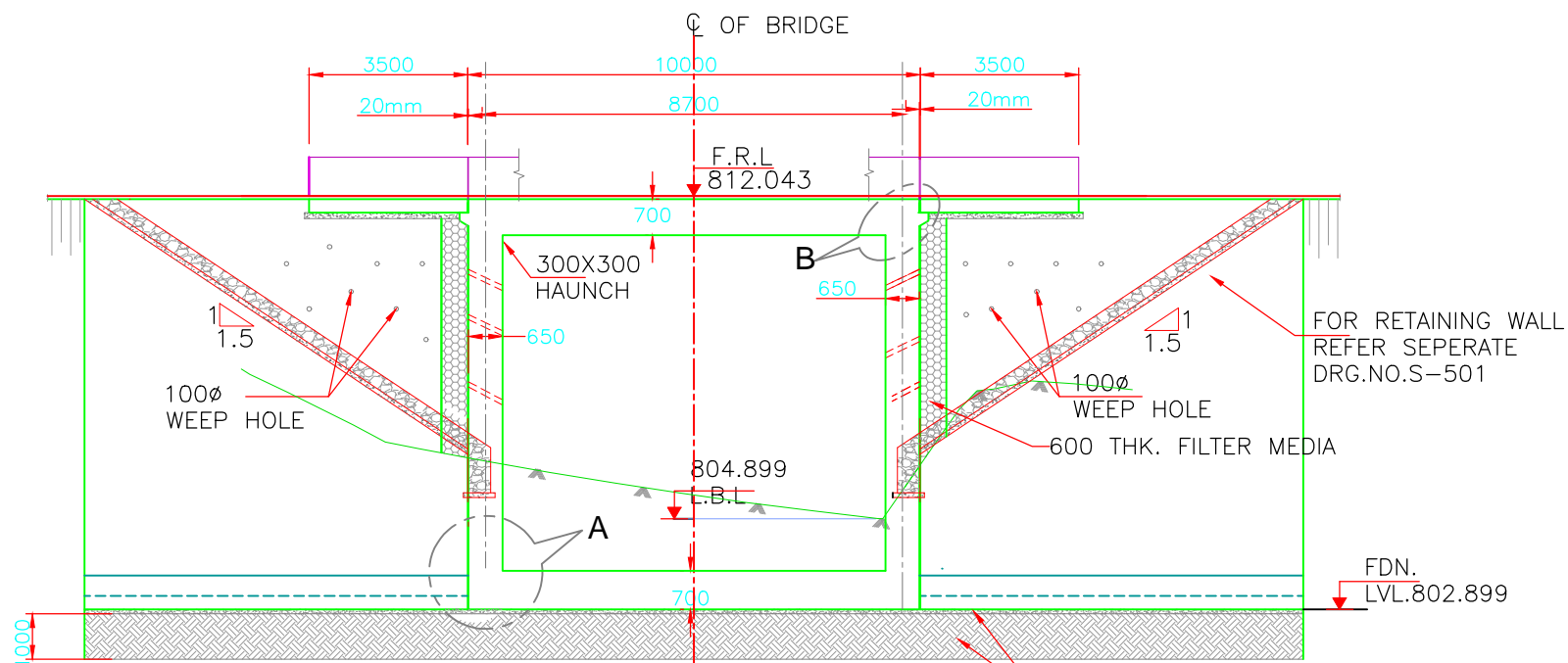

SECTION A-A

(SCALE-1:150)

FORMATION LEVEL	812.043	812.043	812.043
GROUND LEVEL	806.199	805.433	805.637
CHAINAGE (M.)	402+650	402+655	402+660

100MM P.C.C. (M-15)
OVER 1000 COMPACTED
EARTH/SUBSOIL

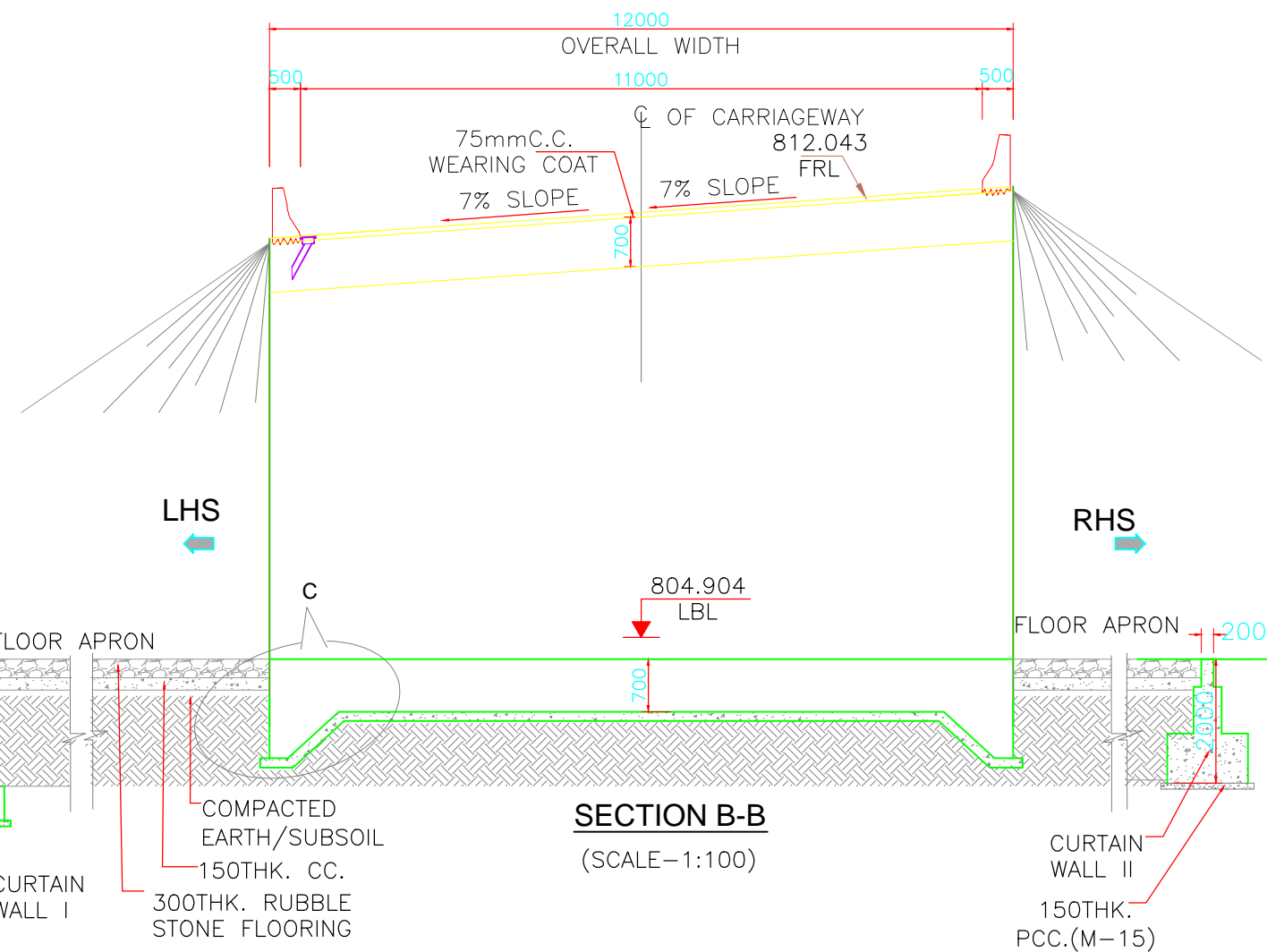

SECTION B-B

(SCALE-1:100)

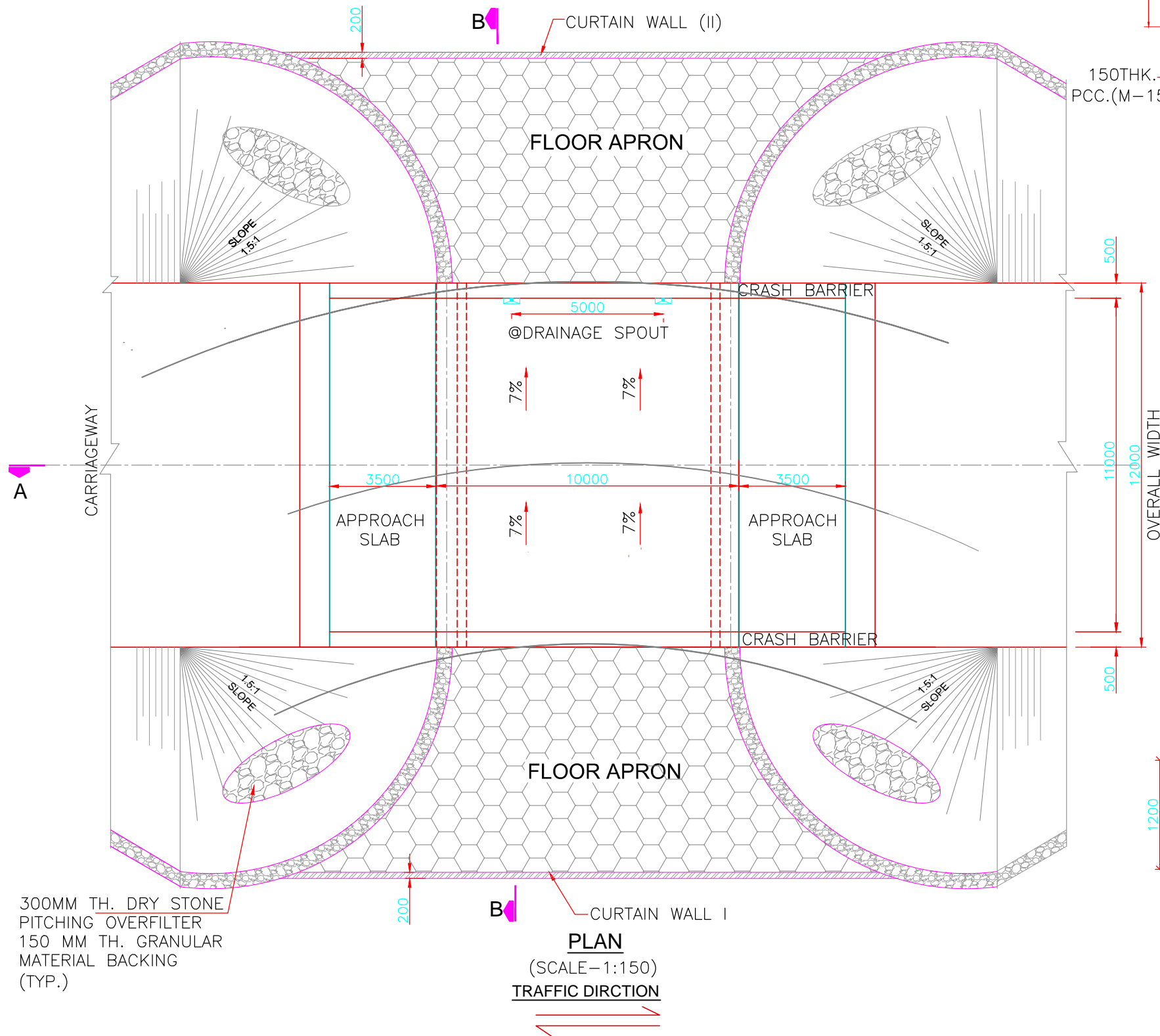

PLAN

(SCALE-1:150)

TRAFFIC DIRECTION

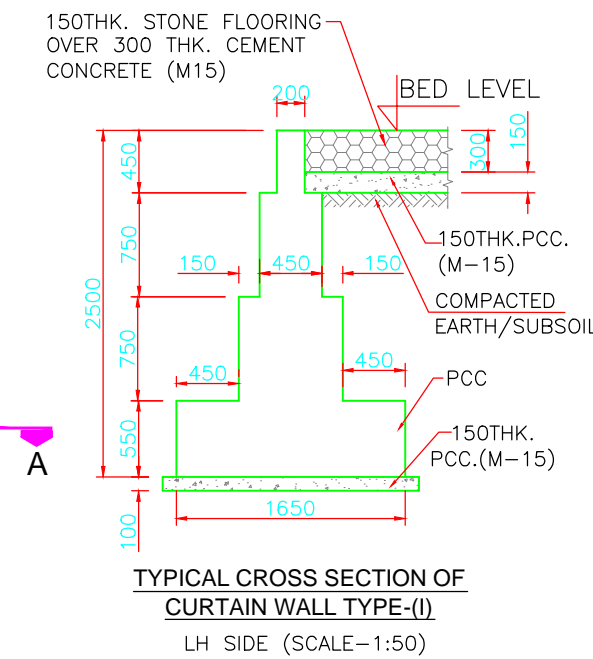
TYPICAL CROSS SECTION OF
CURTAIN WALL TYPE-(I)

LH SIDE (SCALE-1:50)

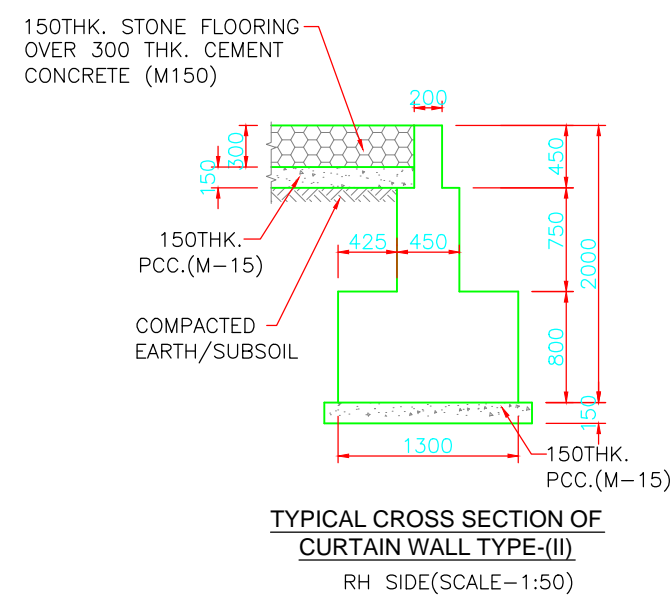
TYPICAL CROSS SECTION OF
CURTAIN WALL TYPE-(II)

RH SIDE (SCALE-1:50)

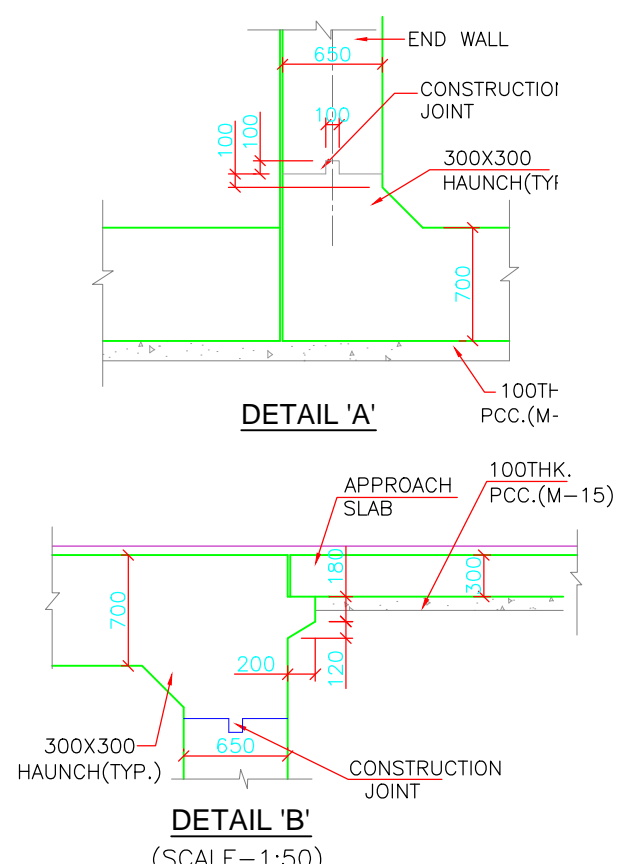

DETAIL 'A'

DETAIL 'B'

(SCALE-1:50)

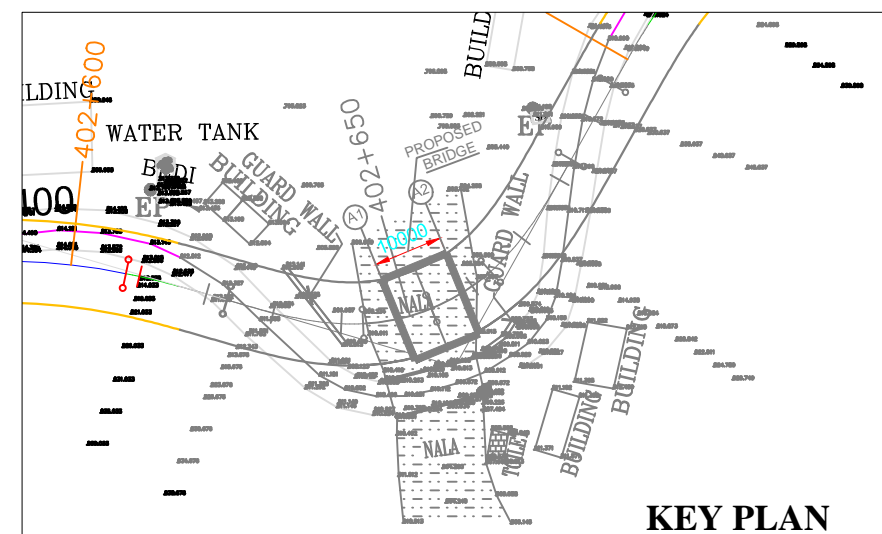

KEY PLAN

FOR PLANNING

FOR APPROVAL

FOR CONSTRUCTION

AS BUILT

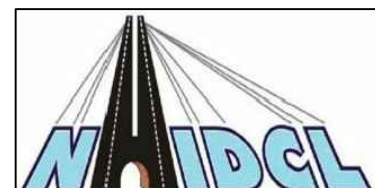

National Highways and Infrastructure
Development Corporation

PROJECT TITLE :-

CONSTRUCTION & UPGRADATION OF EXISTING ROAD TO 2-LANE WITH PAVED SHOULDERS FROM KM 399.000 TO KM 430.000 OF KARANPRAYAG TO CHAMOLI (EXCLUDING KM 420.250 TO KM 420.500 AND KM 423.300 TO KM 423.650) OF NH-07 UNDER CHARDHAM PARIYOJNA ON EPC BASICS IN THE STATE OF UTTARAKHAND (PKG-II)

REV	DATE	DESCRIPTION	SIGN

TITLE :-
GENERAL ARRANGEMENT DRAWING FOR
SOLID SLAB 10M AT CH.402+655 BOX CULVERT

DWG. NO. NHIDCL/NH-07/MNB/ CH.402+655.10M.S-101

DRN:-	DGN:-	CHK:-	DATE:-	SCALE:-	SHEET SIZE
ALI	P.V.M	V.P.S	JAN 2018	AS SHOWN	SHEET NO:- A2 01 OF 01

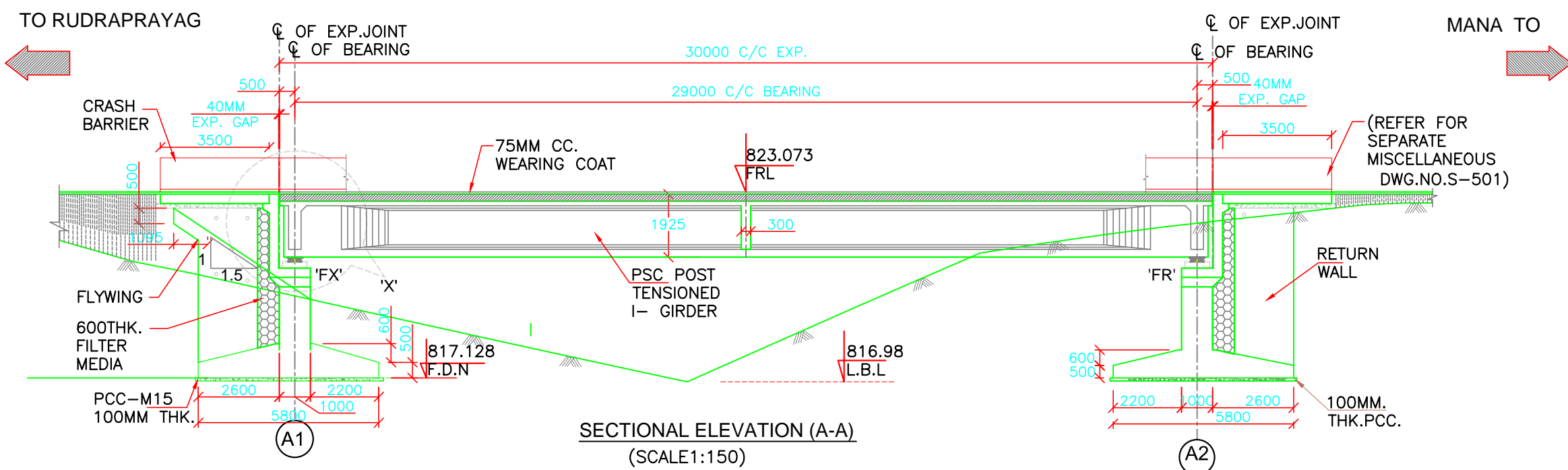

FRL.	823.073	823.073	823.073
G.L.	819.628	816.98	822.020
CH.(M)	404+650	404+665	404+680

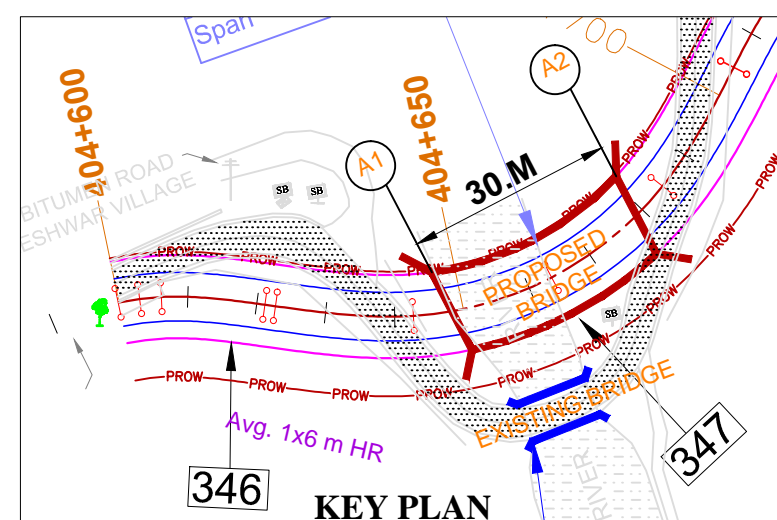
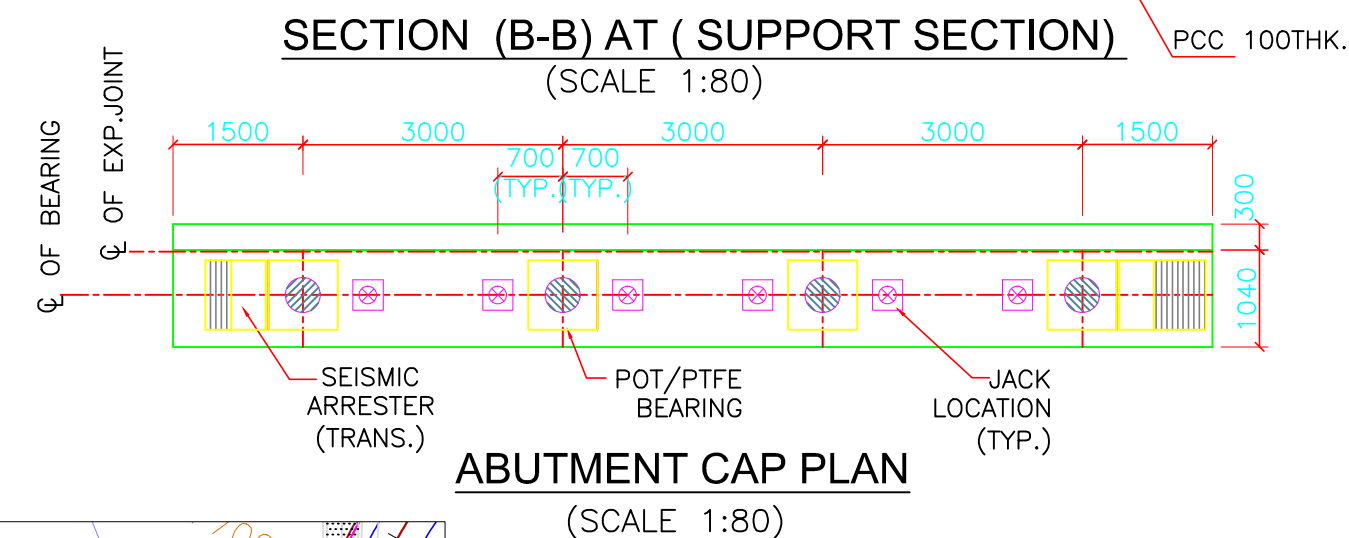
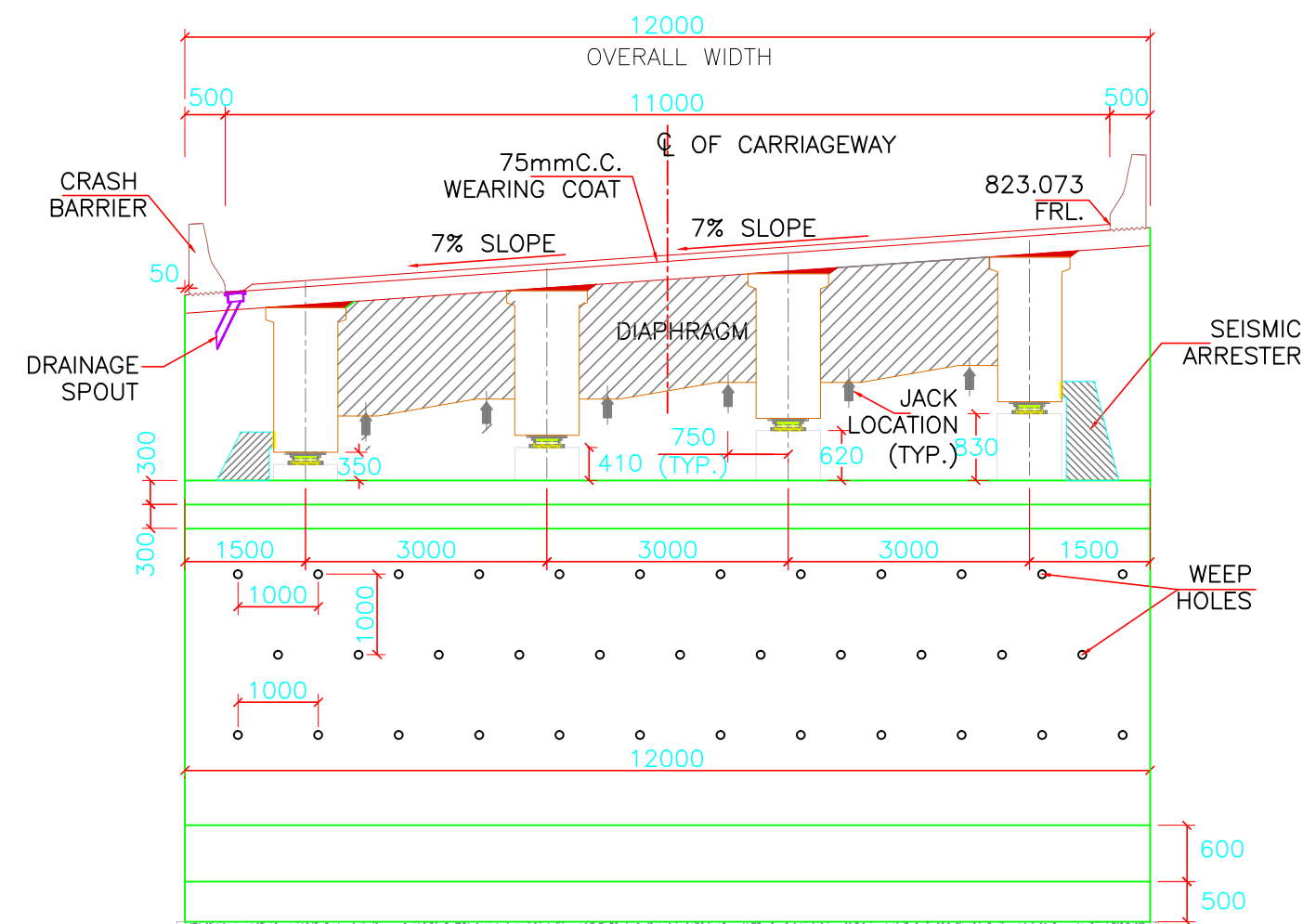
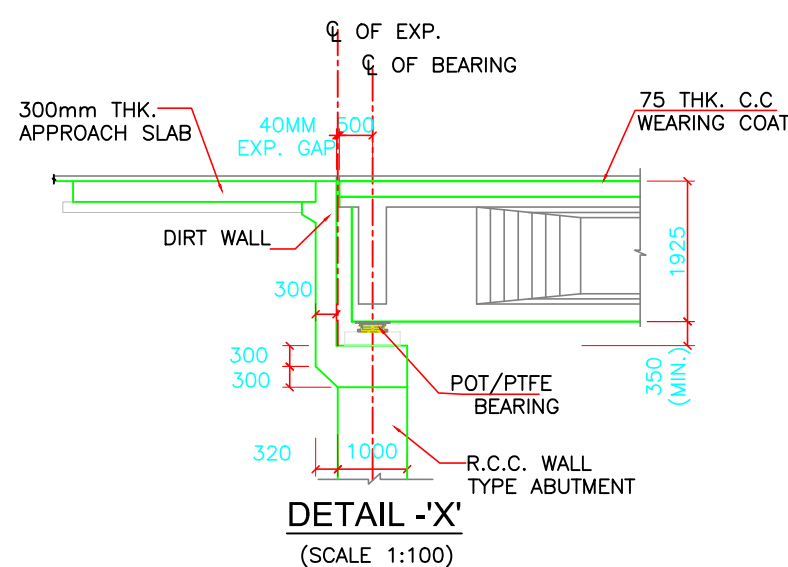
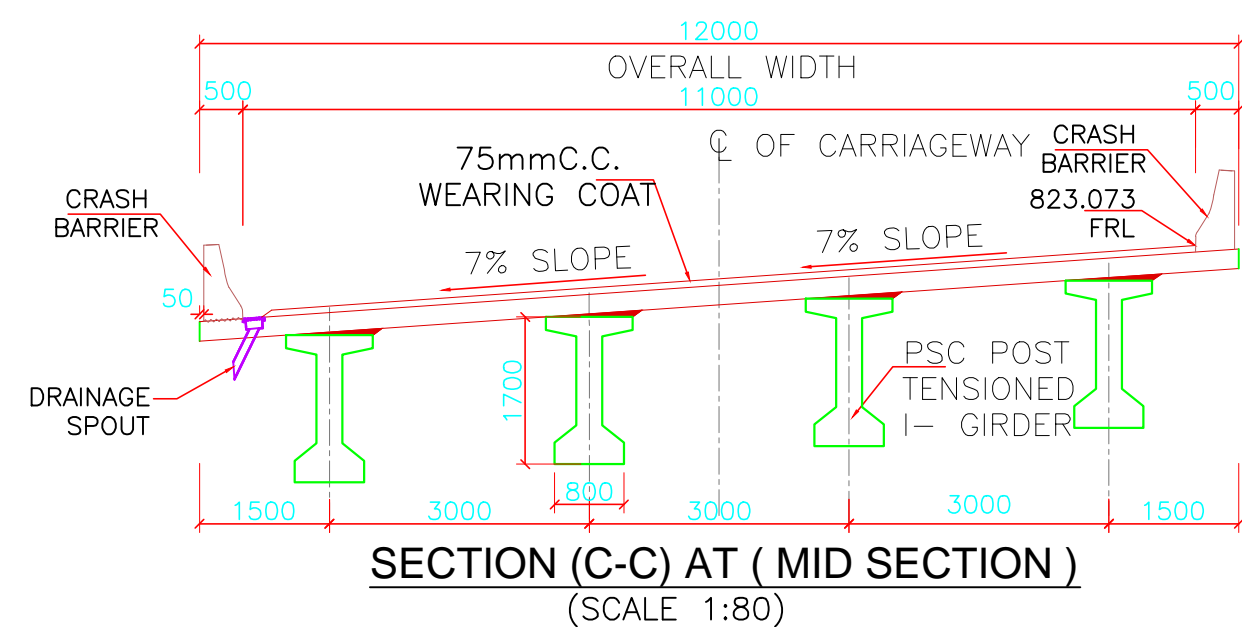
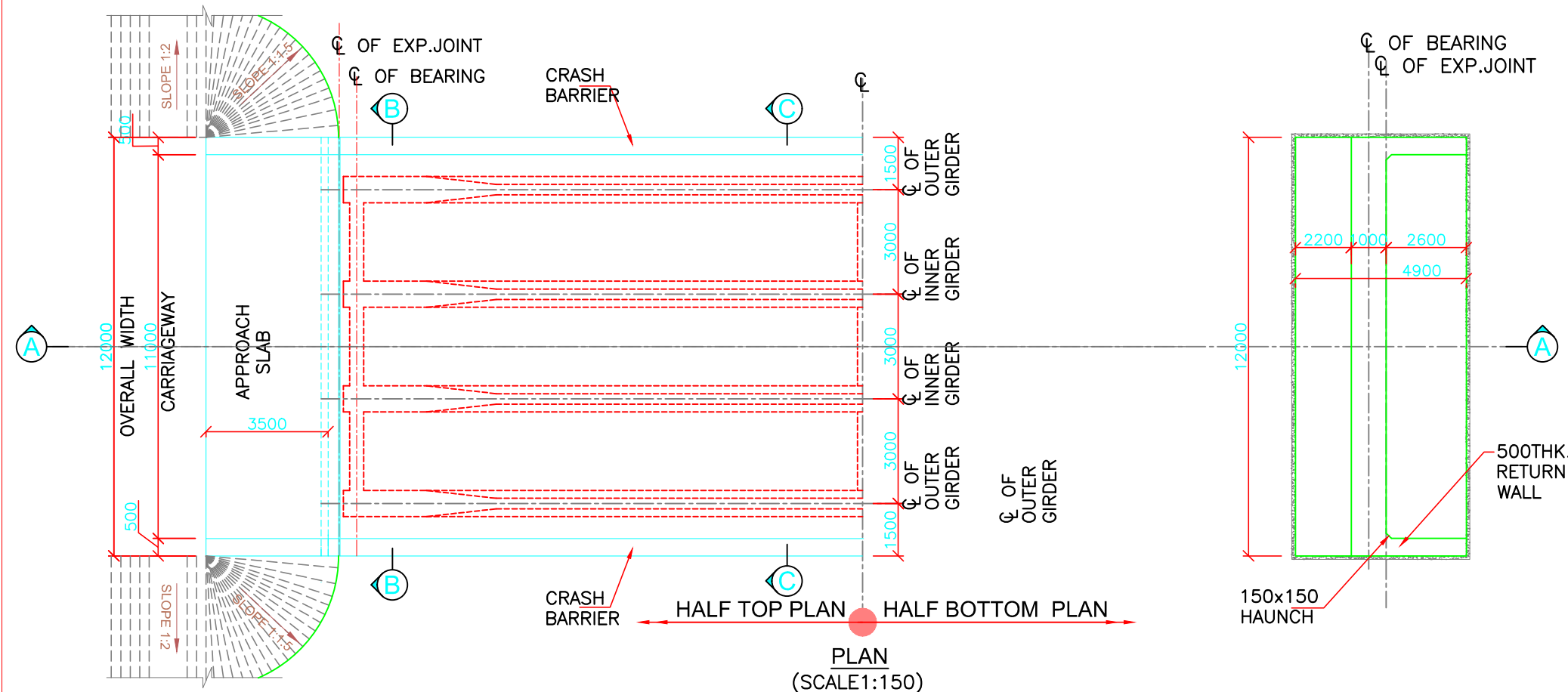

NOTES :-

- ALL DIMENSIONS ARE IN MILLIMETERS UNLESS OTHERWISE MENTIONED. ONLY WRITTEN DIMENSIONS SHALL BE FOLLOWED.
- THIS DRAWING SHALL BE READ IN CONJUNCTION WITH ALL OTHER DRAWINGS.
- PROPOSED BRIDGE IS DESIGNED FOR 3 LANE OF CLASS A, OR SINGLE LANE OF 70R OF +1 LANE CLASS A WHICHEVER GOVERNS.
- ALL DIMENSIONS ARE TANTATIVE SUBJECTED TO CHANGE DURING DETAILED DESIGN

- GRADE OF CONCRETE FOR VARIOUS STRUCTURES SHALL BE AS FOLLOWS -
P.C.C. LEVELLING COURSE = M15
SUPERSTRUCTURE = M45
SUBSTRUCTURE = M35
APPROACH SLAB = M30
RETURN/WING WALLS = M35
CRASH BARRIER = M40

- GRADE OF STEEL- Fe 500D CONFORMING TO IS:1786-1985.

- THE SELECTED EARTH FILL BEHIND ABUTMENT SHALL HAVE FOLLOWING PROPERTIES WHICH HAVE BEEN ASSUMED FOR DESIGN OF ABUTMENTS
FOUNDATION, PARAMETERS $\phi=30^\circ$, γ dry = 18 kN/m³ AS PER IRC-78

- 100 DIA. WEAP HOLES ARE TO BE PROVIDED @1000 C/C IN STAGGERED MANNER (BOTH HORIZONTALLY & VERTICALLY) IN 1:20 SLOPE

- (i) CLEAR COVER TO OUTER MOST STEEL IS 50mm FOR ALL COMPONENTS EXCEPT FOUNDATIONS.
(ii) CLEAR COVER TO OUTER MOST STEEL IS 75mm FOR FOUNDATION.

- EXPANSION JOINT SHALL BE TYPE:- STRIP SEAL

- PROTECTION WORK SHALL BE PROVIDED AS PER IRC 89:1977.

- IT MAY BE ENSURED THAT MINIMUM EMBEDMENT OF FOUNDATION IS 1.5M IN SOFT ROCK OR 0.6M IN HARD ROCK AS PER PROVISION OF OR IRC 78.

CLIENT:-

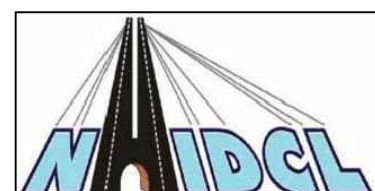

National Highways and Infrastructure
Development Corporation

PROJECT TITLE :-

CONSTRUCTION & UPGRADATION OF EXISTING ROAD TO 2-LANE WITH PAVED SHOULDERS FROM KM 399.000 TO KM 430.000 OF KARANPRAYAG TO CHAMOLI (EXCLUDING KM 420.250 TO KM 420.500 AND KM 423.300 TO KM 423.650) OF NH-07 UNDER CHARDHAM PARIYOJNA ON EPC BASICS IN THE STATE OF UTTAKHAND (PKG-II)

REV	DATE	DESCRIPTION	SIGN
R1	JAN.2017	CARRIAGEWAY REVISED	Y.P.S

TITLE :- GENERAL ARRANGEMENT DRAWING MNB 1X30M PSC AT (CH.404+655)					
DWG. NO. NHIDCL /NH-07 /MNB /S-101					
DRN:-	DGN:-	CHK:-	DATE:-	SCALE:-	SHEET SIZE
PRAVEEN	P.V.M	V.P.S	JAN. 2018	AS SHOWN	A2
					SHEET NO:-
					01 OF 01

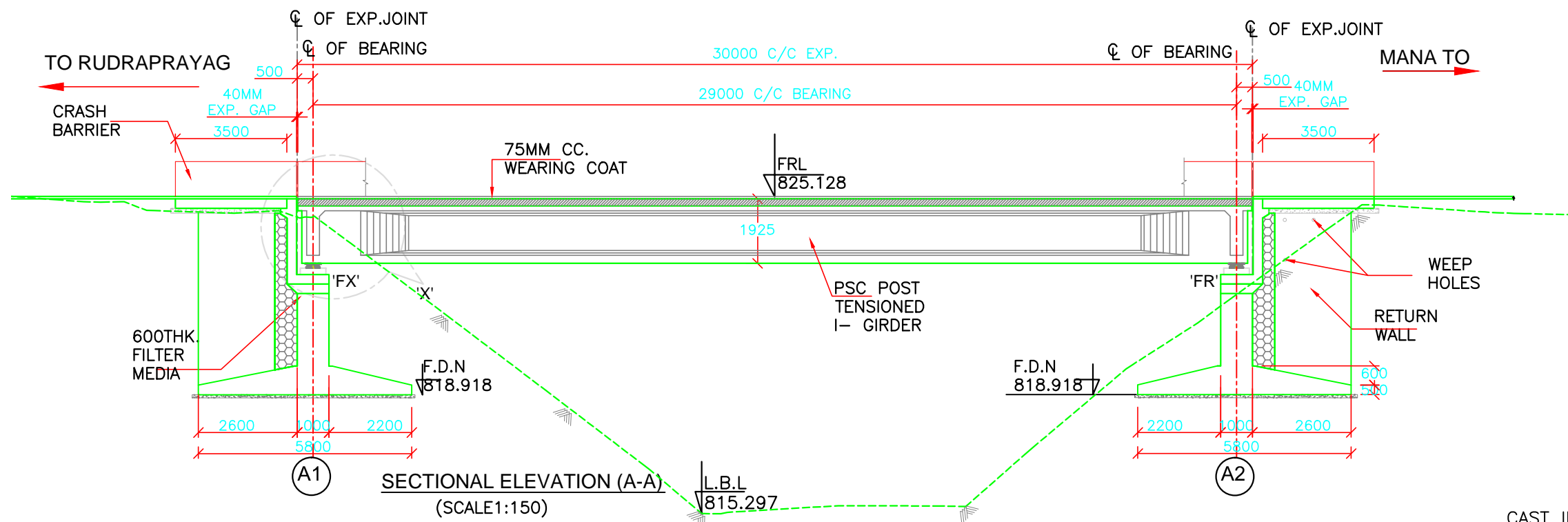

F.R.L.	825.128	825.128	825.128
G.L.	824.492	815.297	822.051
CH.(M)	406+090	406+100	406+110

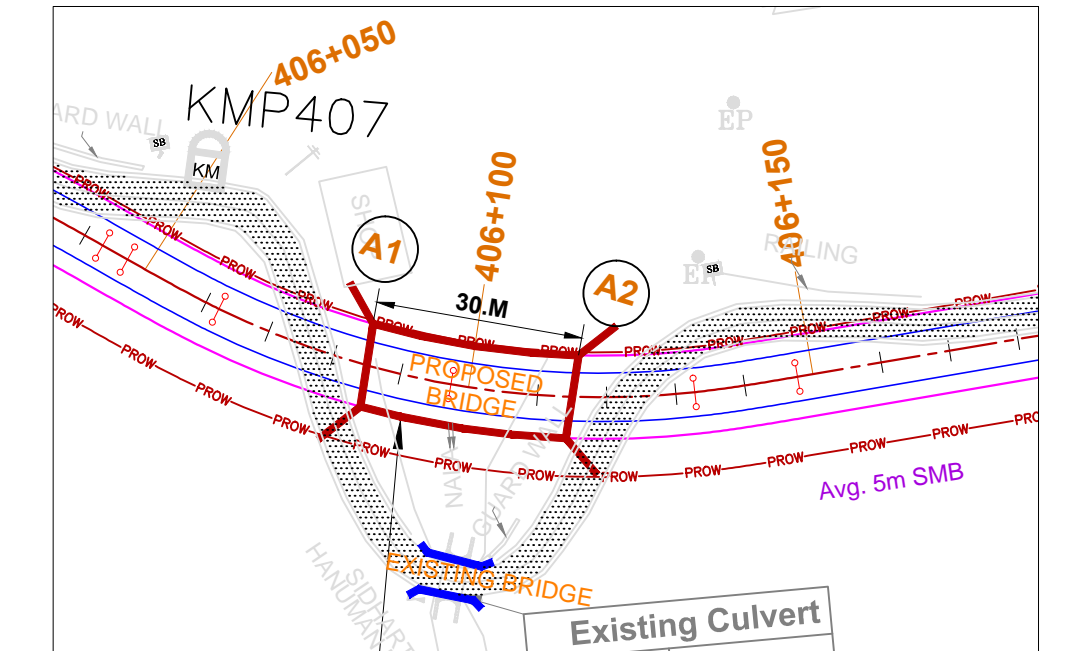
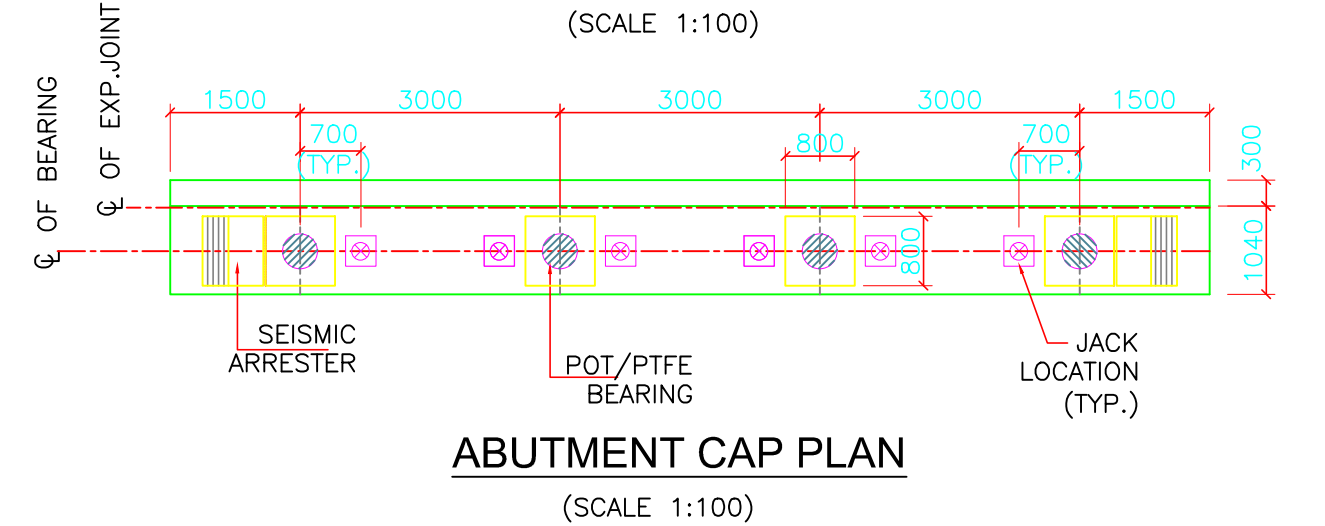
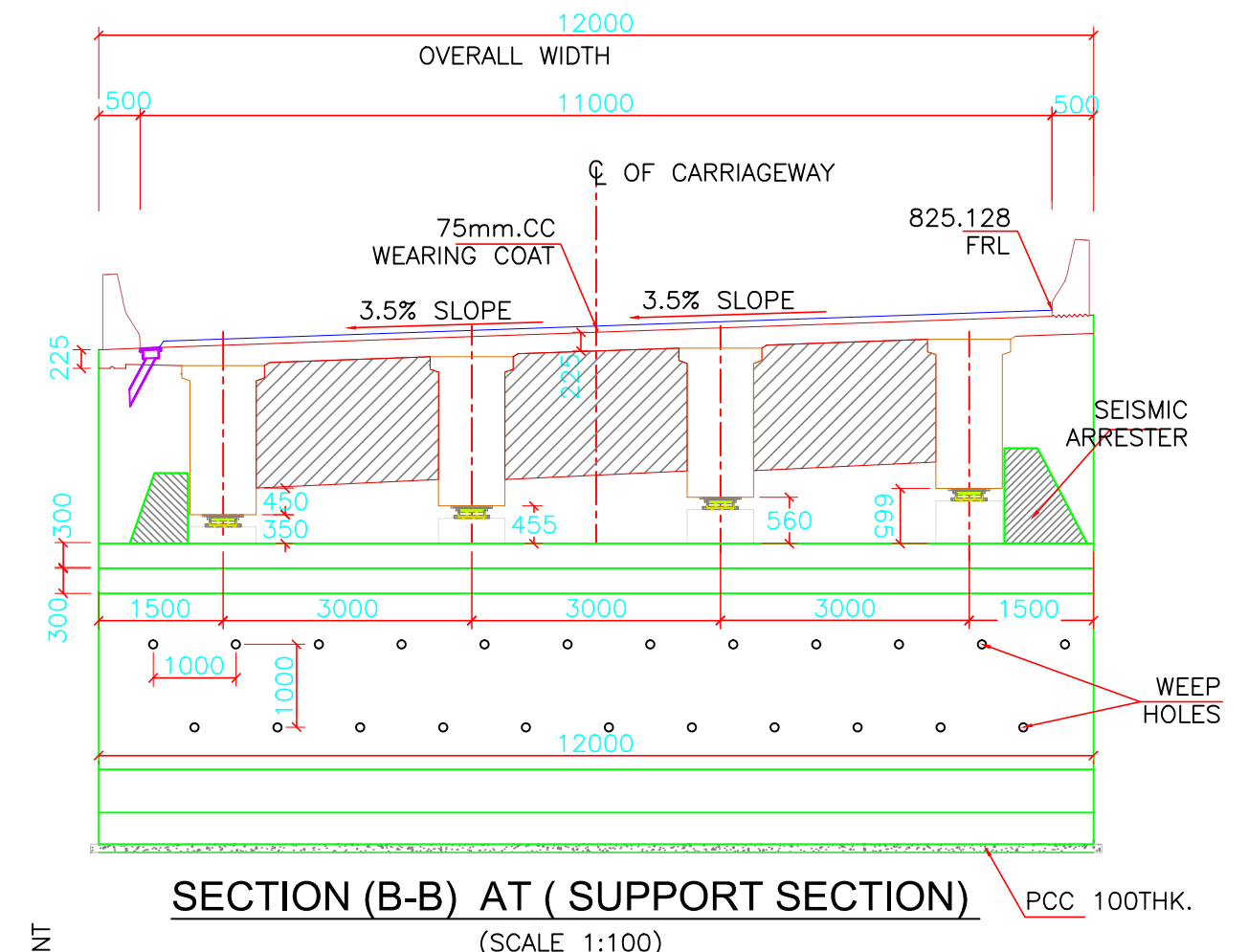
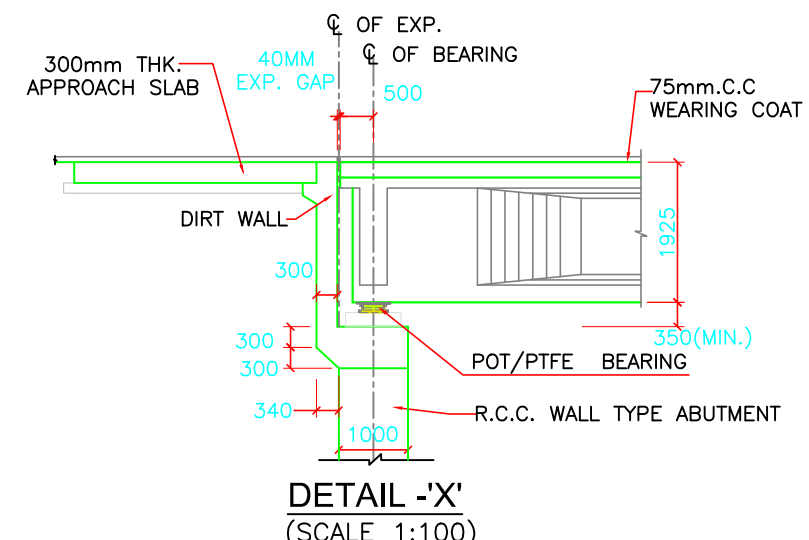
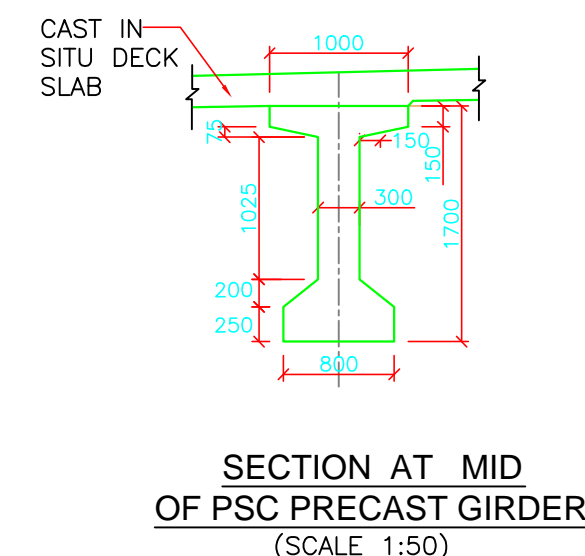
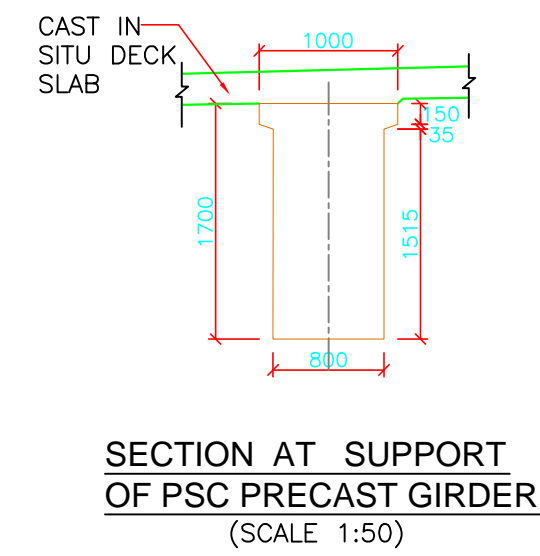
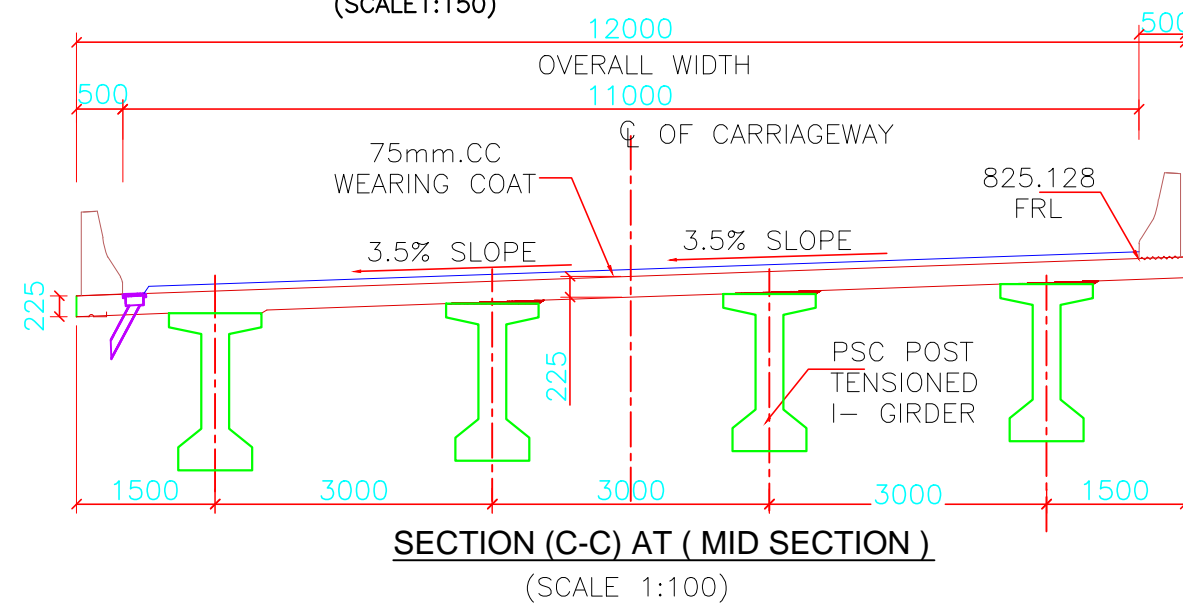
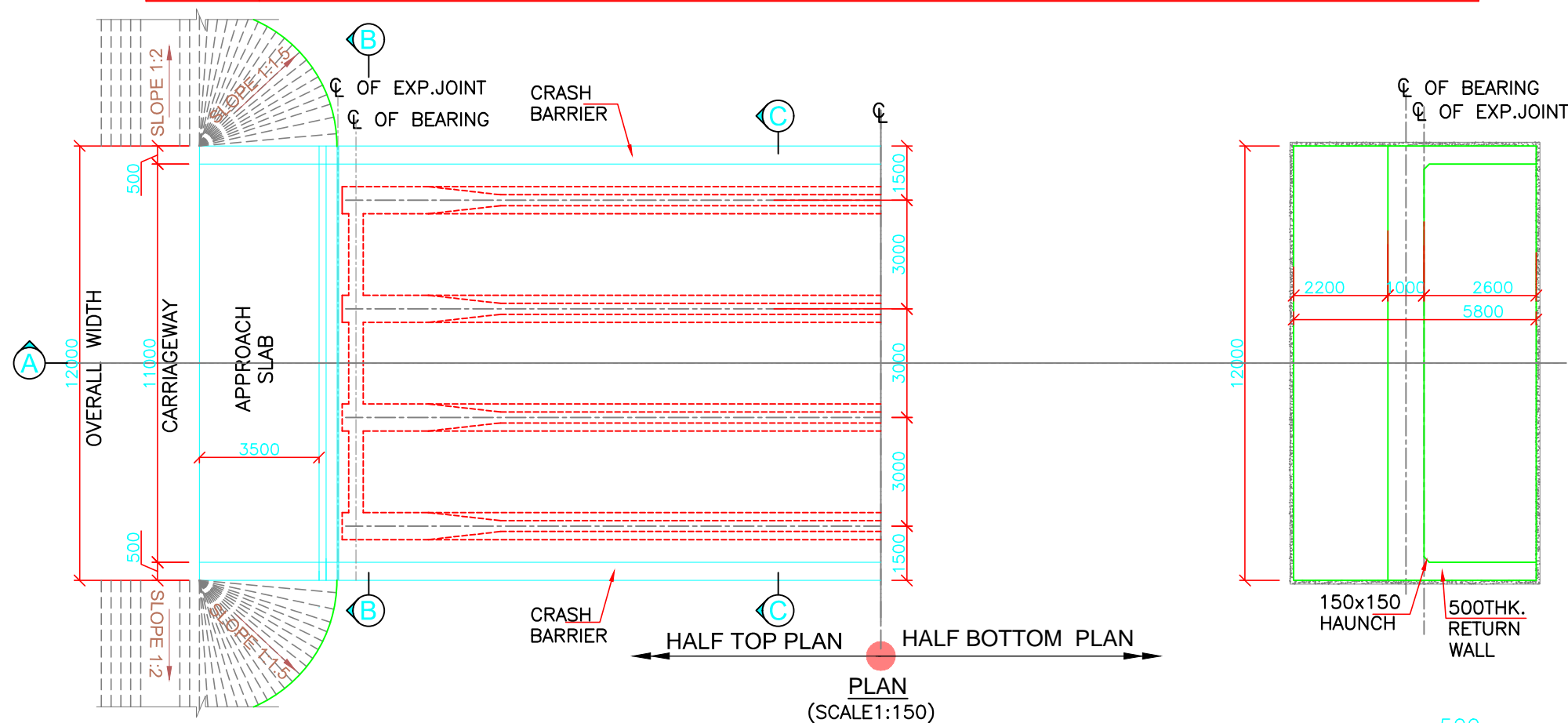

KEY PLAN

FOR PLANNING	<input type="radio"/>
FOR APPROVAL	<input checked="" type="radio"/>
FOR CONSTRUCTION	<input type="radio"/>
AS BUILT	<input type="radio"/>

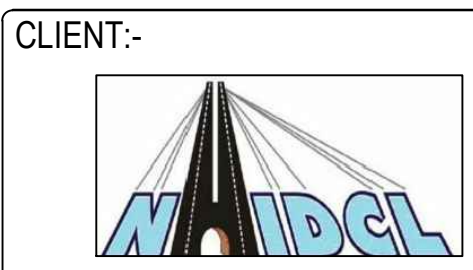

National Highways and Infrastructure Development Corporation

PROJECT TITLE :-
CONSTRUCTION & UPGRADATION OF EXISTING ROAD TO 2-LANE WITH PAVED SHOULDERS FROM KM 399.000 TO KM 430.000 OF KARANPRAYAG TO CHAMOLI (EXCLUDING KM 420.250 TO KM 420.500 AND KM 423.300 TO KM 423.650) OF NH-07 UNDER CHARDHAM PARIYOJNA ON EPC BASICS IN THE STATE OF UTTARAKHAND (PKG-II)

REV	DATE	DESCRIPTION	SIGN
R1	JAN 2017	CARRIAGEWAY REVISED	Y.P.S

TITLE :- GENERAL ARRANGEMENT DRAWING MNB 1X30M PSC AT (CH.406+100)					
DWG. NO. NHIDCL /NH-07 /MNB /CH.406+100/S-101					
DRN:-	DGN:-	CHK:-	DATE:-	SCALE:-	SHEET SIZE
PRAVEEN	P.V.M	V.P.S	JAN. 2018	AS SHOWN	A2
					SHEET NO:- 01 OF 01

SHEET SIZE
A2
SHEET NO:-
01 OF 01

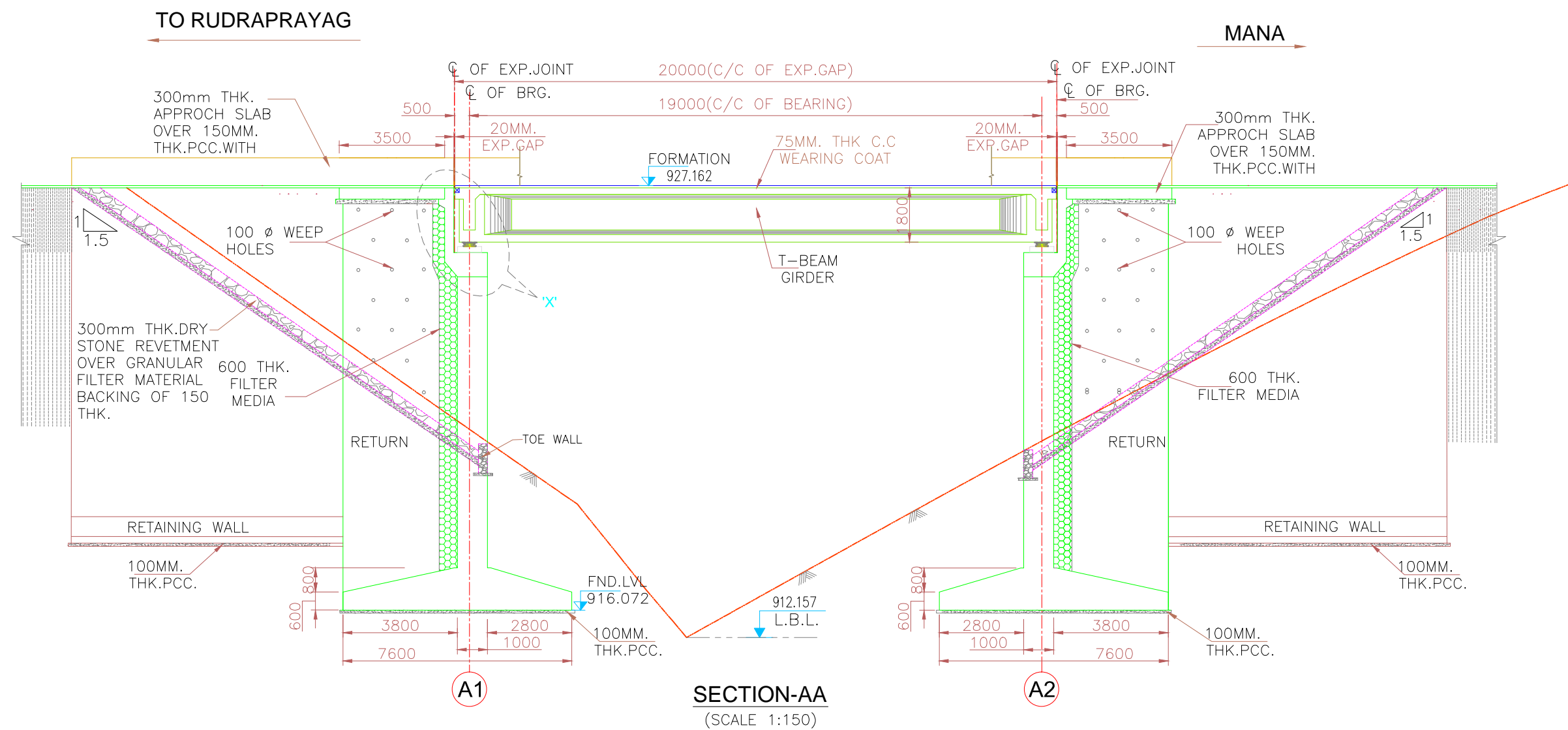

FRL LEVEL	927.162	927.162	927.162
GROUND LEVEL	919.072	913.440	918.682
CHAINAGE (M.)	409+125	409+135	409+145

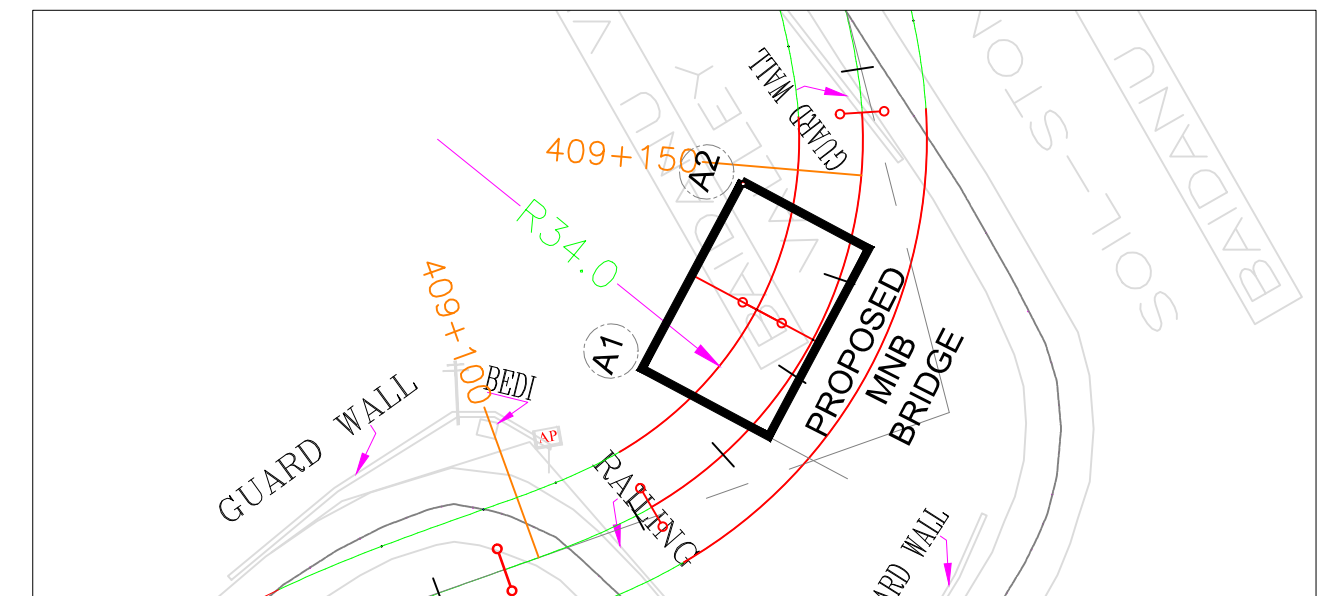
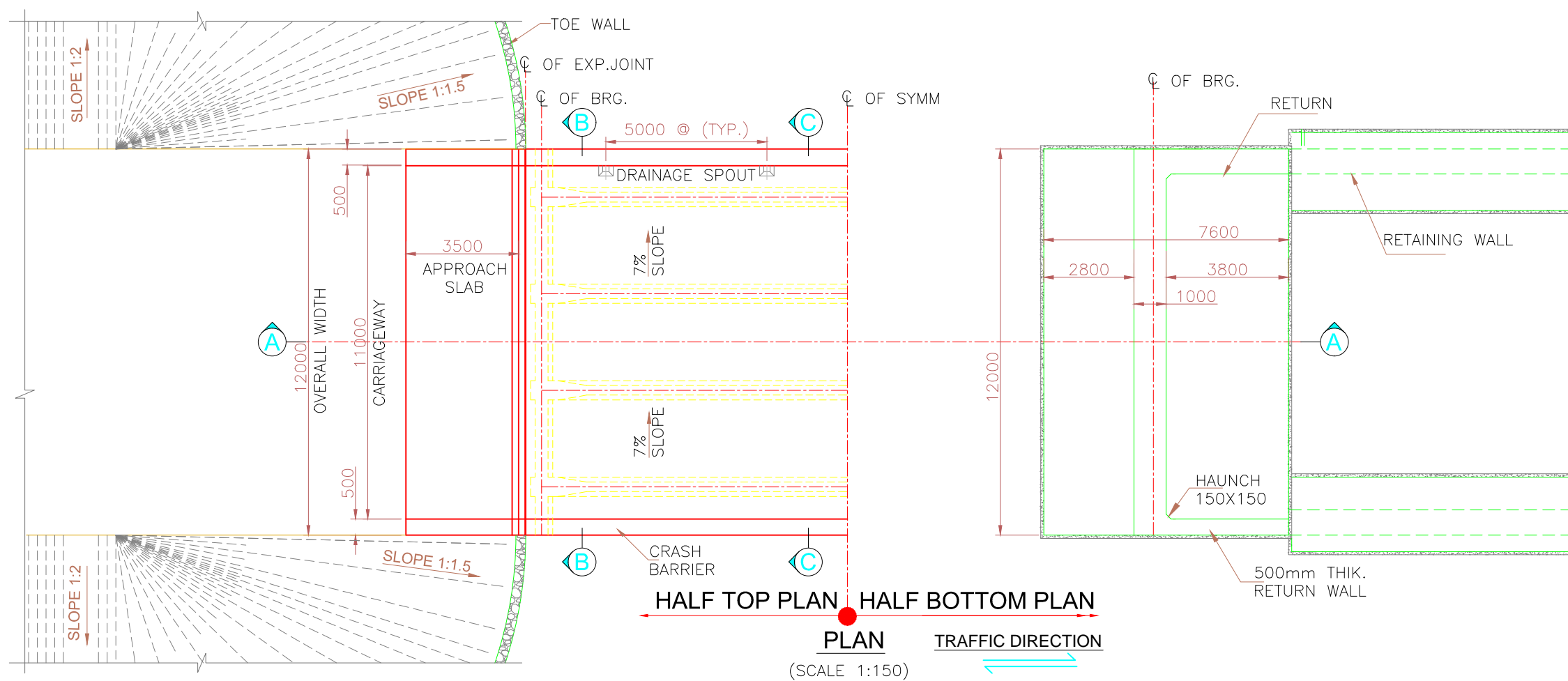
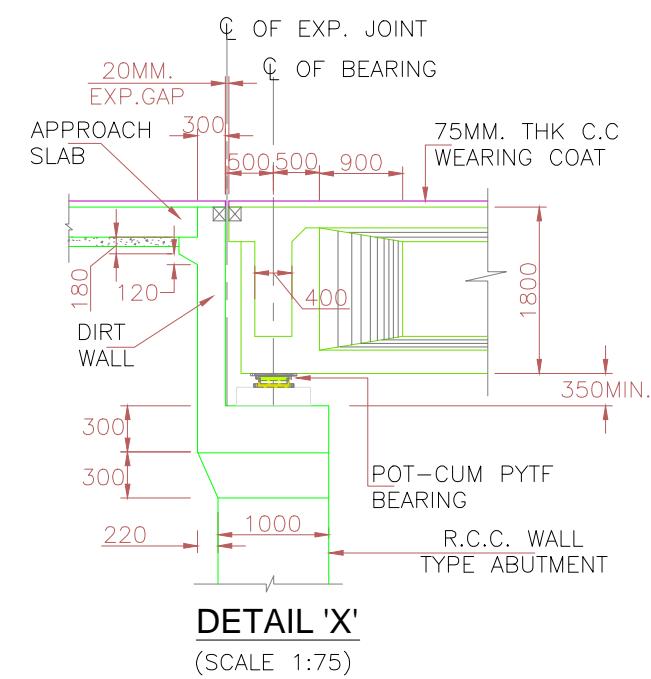

CLIENT:-



National Highways and Infrastructure
Development Corporation

PROJECT TITLE :-

CONSTRUCTION & UPGRADATION OF EXISTING ROAD TO 2-LANE
WITH PAVED SHOULDERS FROM KM 399.000 TO KM 430.000 OF
KARANPRAYAG TO CHAMOLI (EXCLUDING KM 420.250 TO KM
420.500 AND KM 423.300 TO KM 423.650) OF NH-07 UNDER
CHARDHAM PARIYOJNA ON EPC BASICS IN THE STATE OF
UTTRAKHAND (PKG-II)

REV	DATE	DESCRIPTION	SIGN
R1	NOV.2016	CARRIAGEWAY REVISED	Y.P.S

TITLE :- GENERAL ARRANGEMENT DRAWING MNB 1X20M AT (CH.409+135)					
DWG. NO. NHIDCL /NH-07 /MNB /CH.409+135/S-101					
DRN:-	DGN:-	CHK:-	DATE:-	SCALE:-	SHEET SIZE
Y.P.S	P.V.M	V.P.S	JAN. 2018	AS SHOWN	SHEET NO:- A2 01 OF 02

NOTES :-

1. ALL DIMENSIONS ARE IN MILLIMETERS UNLESS OTHERWISE MENTIONED. ONLY WRITTEN DIMENSIONS SHALL BE FOLLOWED.
2. THIS DRAWING SHALL BE READ IN CONJUNCTION WITH ALL OTHER DRAWINGS.
3. GRADE OF CONCRETE FOR VARIOUS STRUCTURES SHALL BE AS FOLLOWS –
P.C.C. LEVELLING COURSE = M15
SUPERSTRUCTURE = M35
SUBSTRUCTURE = M35
R.C.C. RAILING = M25
APPROACH SLAB = M30
RETURN/WING WALLS = M30
4. GRADE OF STEEL– Fe 500 CONFORMING TO IS:1786–1985.
5. THE SELECTED EARTH FILL BEHIND ABUTMENT SHALL HAVE FOLLOWING PROPERTIES WHICH HAVE BEEN ASSUMED FOR DESIGN OF ABUTMENTS FOUNDATION, PARAMETERS $\phi=30^\circ$, $\gamma_{dry} = 18 \text{ kN/m}^3$
6. 100 DIA. WEEP HOLES ARE TO BE PROVIDED @1000 C/C IN STAGGERED MANNER (BOTH HORIZONTALLY & VERTICALLY) IN 1:20 SLOPE (TYP.).
- 7.(i) CLEAR COVER TO OUTER MOST STEEL IS 50mm FOR ALL COMPONENTS EXCEPT FOUNDATIONS.
(ii) CLEAR COVER TO OUTER MOST STEEL IS 75mm FOR FOUNDATION.
8. EXPANSION JOINT :- STRIP SEAL
9. PROTECTION WORK SHALL BE PROVIDED AS PER IRC 89:1977.
10. IT MAY BE ENSURED THAT MINIMUM EMBEDMENT OF FOUNDATION IS 1.5M IN SOFT ROCK OR 0.6M IN HARD ROCK AS PER PROVISION OF OR IRC 78.
11. PROPOSED BRIDGE IS DESIGNED FOR 3 LANE OF CLASS–A OR SINGLE LANE OF 70R OF +1 LANE CLASS A WHICH EVER GOVERNS.

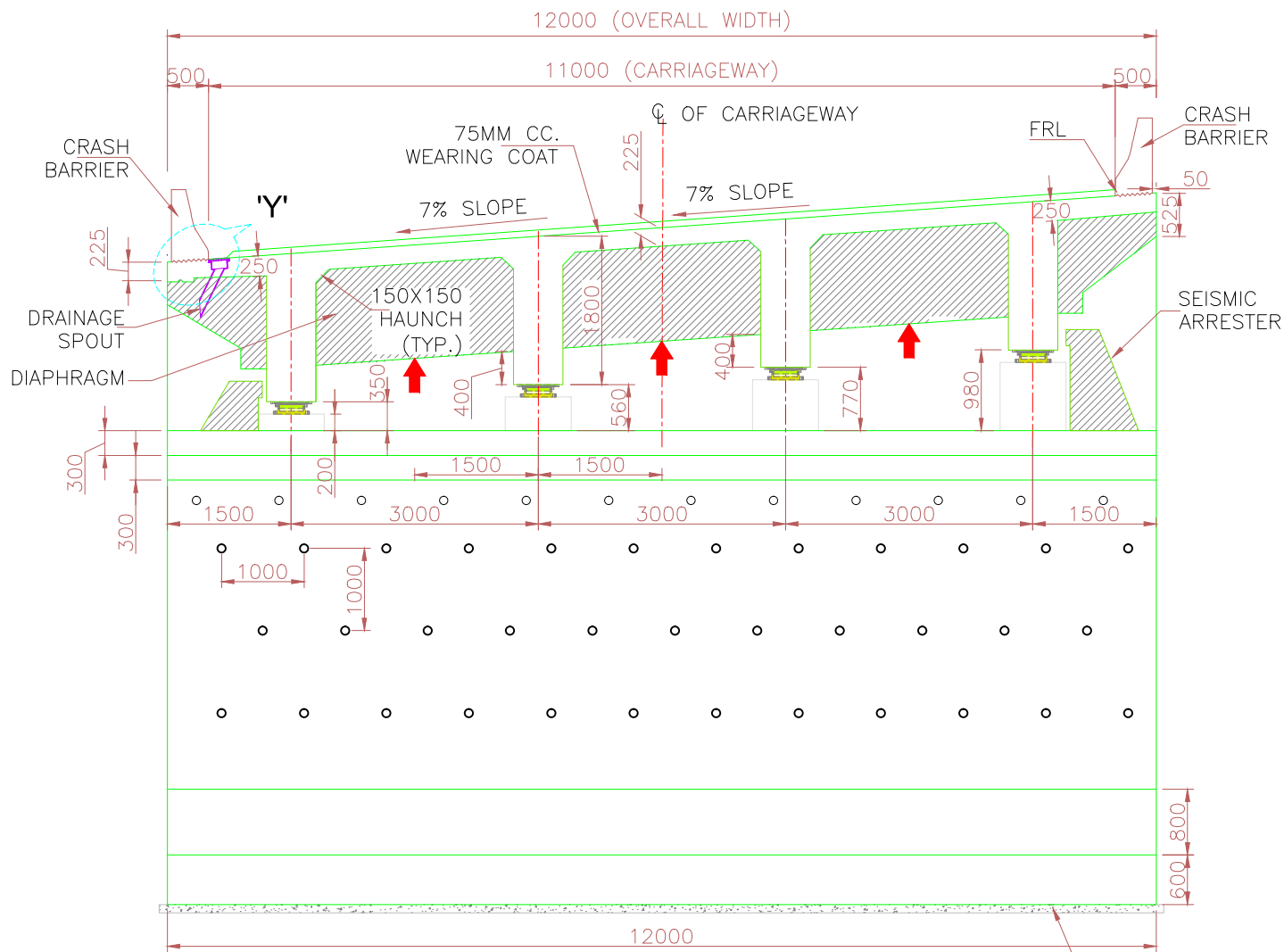

SECTION B-B AT (SUPPORT SECTION)
(SCALE 1:75)

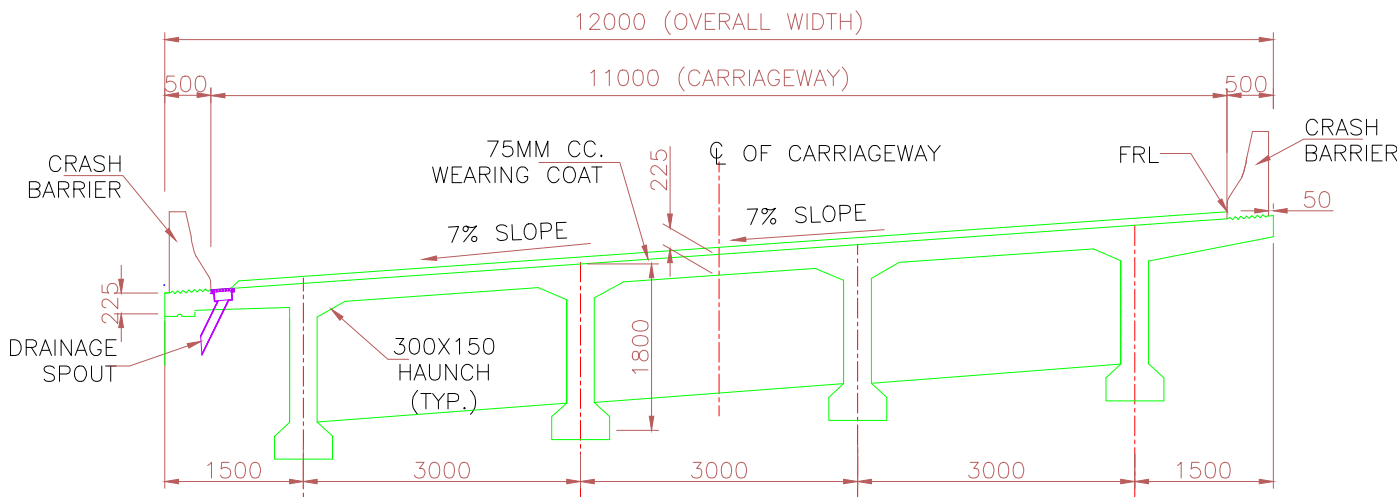

SECTION AT C-C (MID)
(SCALE 1:75)

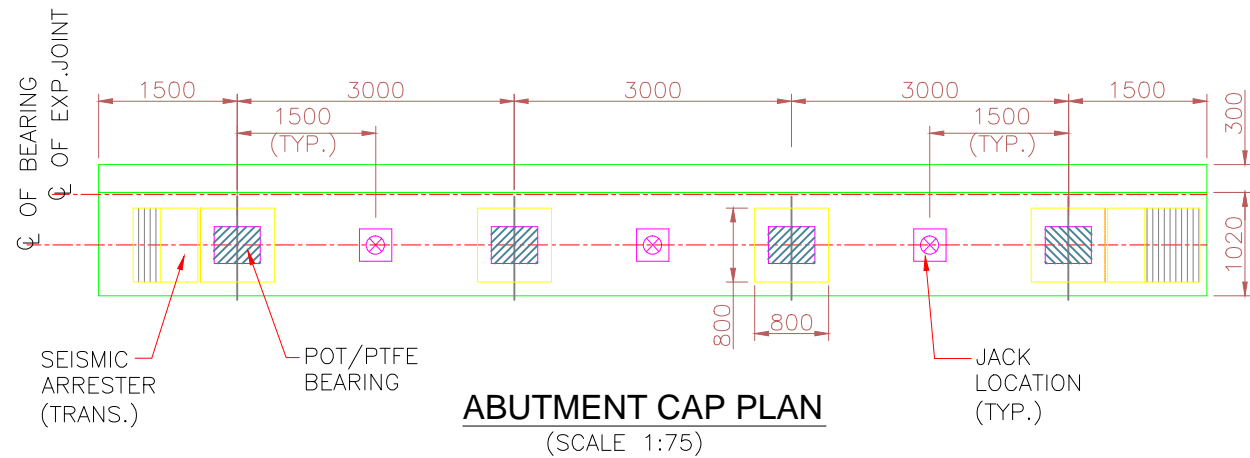

ABUTMENT CAP PLAN
(SCALE 1:75)

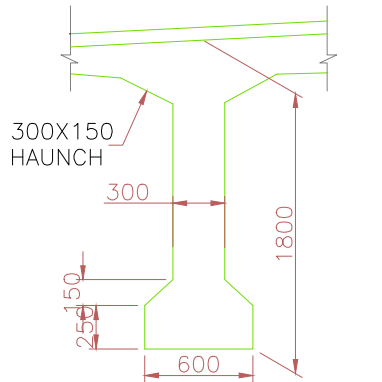

R.C.C GIRDER DETAIL
MID SECTION
(SCALE 1:40)

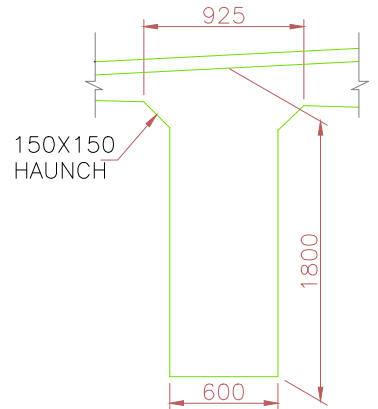

R.C.C GIRDER DETAIL
END SUPPORT SECTION
(SCALE 1:40)

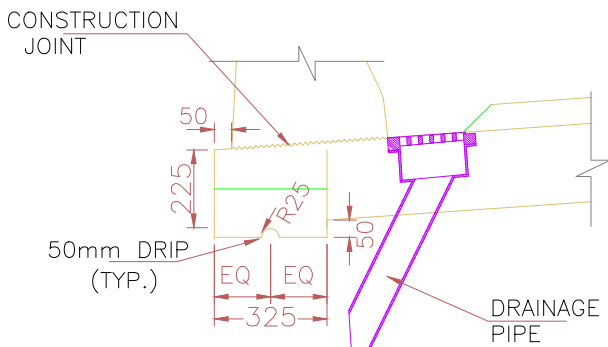

DETAIL 'Y'
(SCALE 1:20)

CLIENT:-

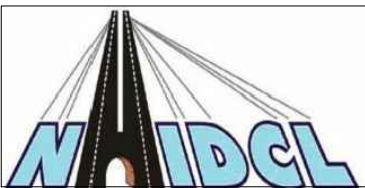

National Highways and Infrastructure
Development Corporation

PROJECT TITLE :-

CONSTRUCTION & UPGRADATION OF EXISTING ROAD TO 2-LANE WITH PAVED SHOULDERS FROM KM 399.000 TO KM 430.000 OF KARANPRAYAG TO CHAMOLI (EXCLUDING KM 420.250 TO KM 420.500 AND KM 423.300 TO KM 423.650) OF NH-07 UNDER CHARDHAM PARIYOJNA ON EPC BASICS IN THE STATE OF UTTARAKHAND (PKG-II)

REV	DATE	DESCRIPTION	SIGN
R1	NOV.2016	CARRIAGEWAY REVISED	Y.P.S

TITLE :-					
GENERAL ARRANGEMENT DRAWING MNB 1X20M AT (CH.409+135)					
DWG. NO. NHIDCL /NH-07 /MNB /CH.409+135/S-101					
DRN:-	DGN:-	CHK:-	DATE:-	SCALE:-	SHEET SIZE
Y.P.S	P.V.M	V.P.S	JAN. 2018	AS SHOWN	SHEET NO:- A2 02 OF 02

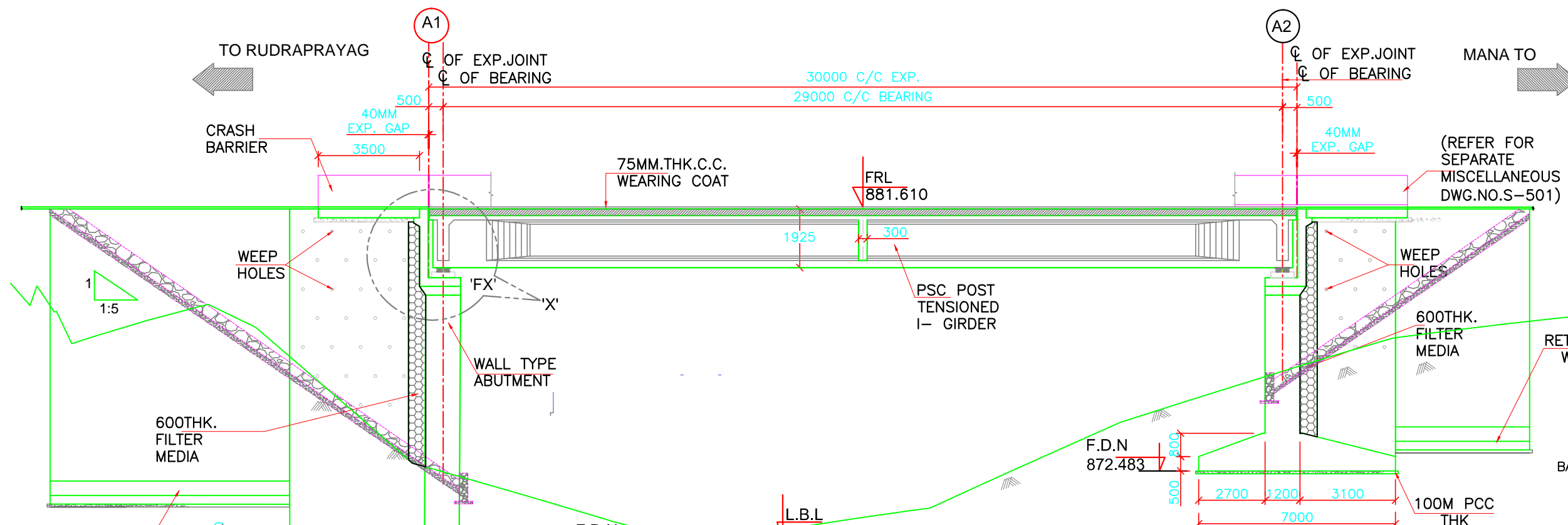

SECTIONAL ELEVATION (SCALE 1:150)			
F.R.L.	881.610	881.610	881.610
G.L.	872.450	870.873	875.930
CH.(M)	410+375	410+390	410+405

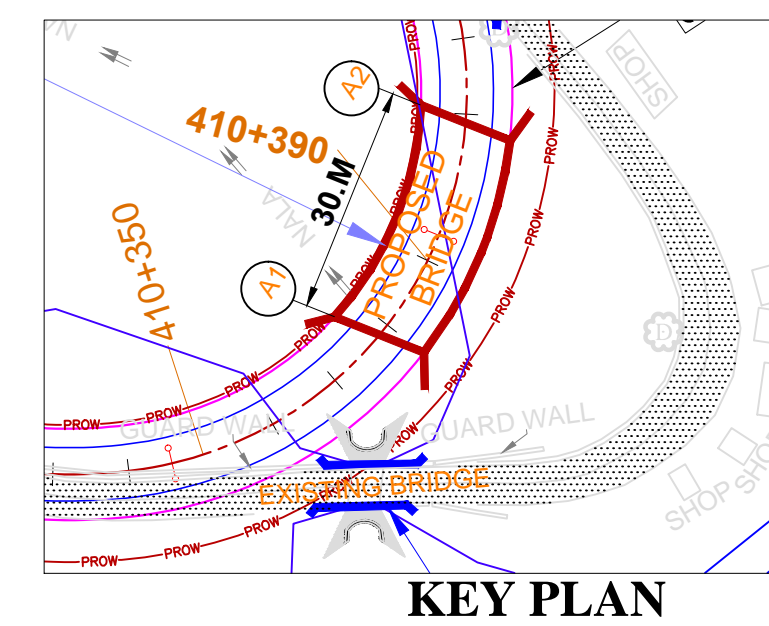
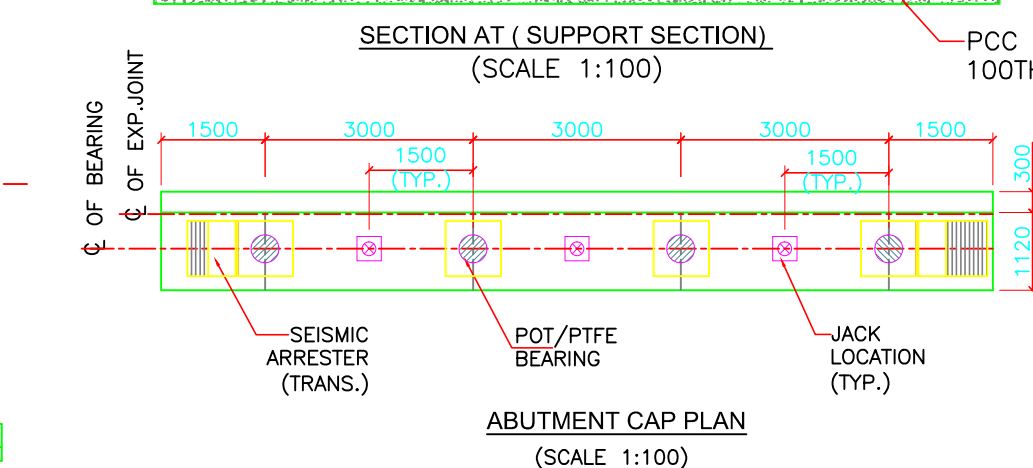
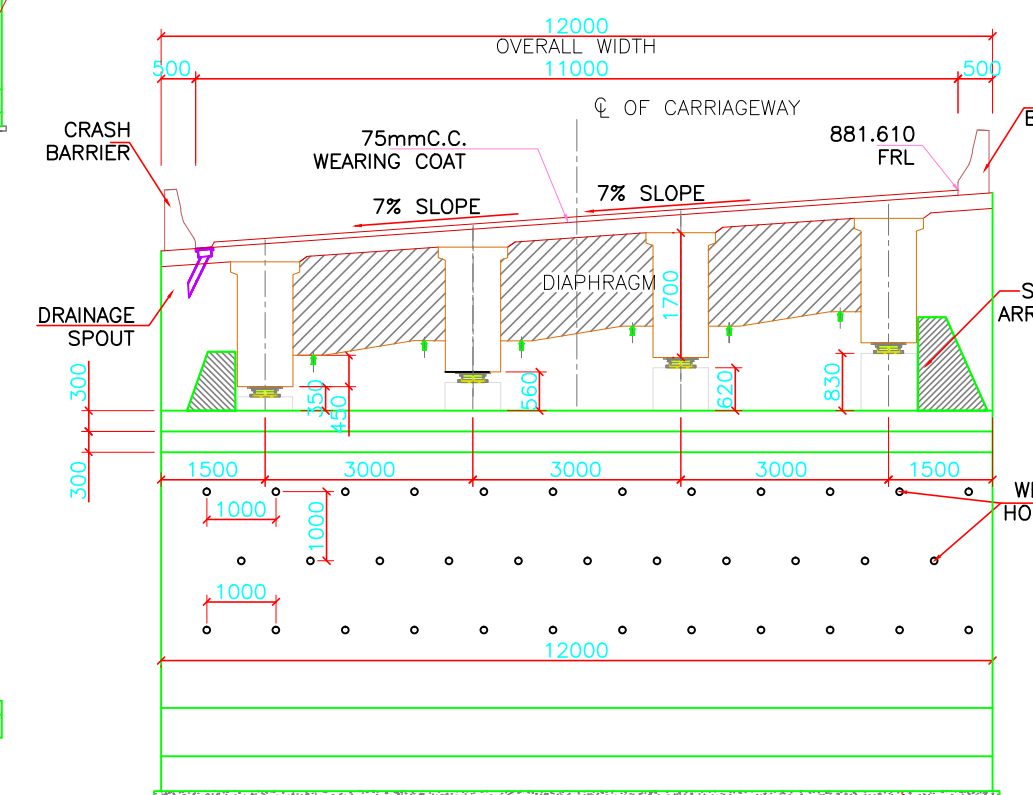
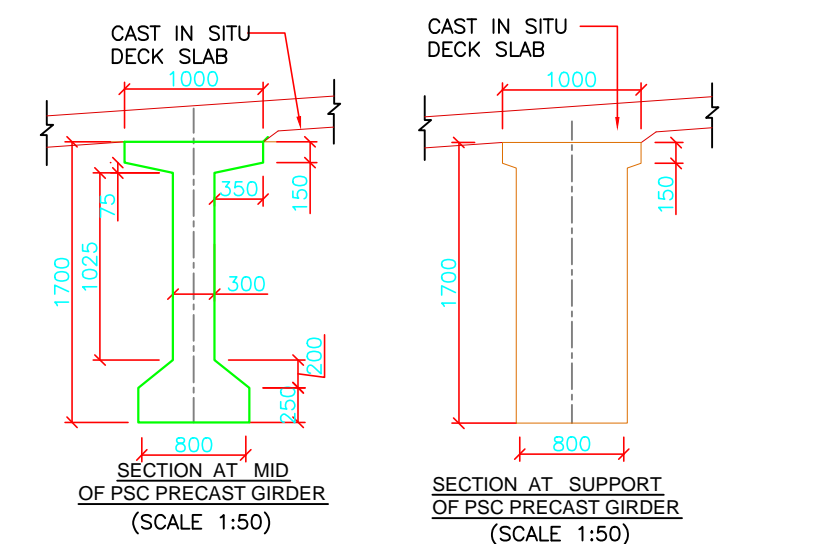
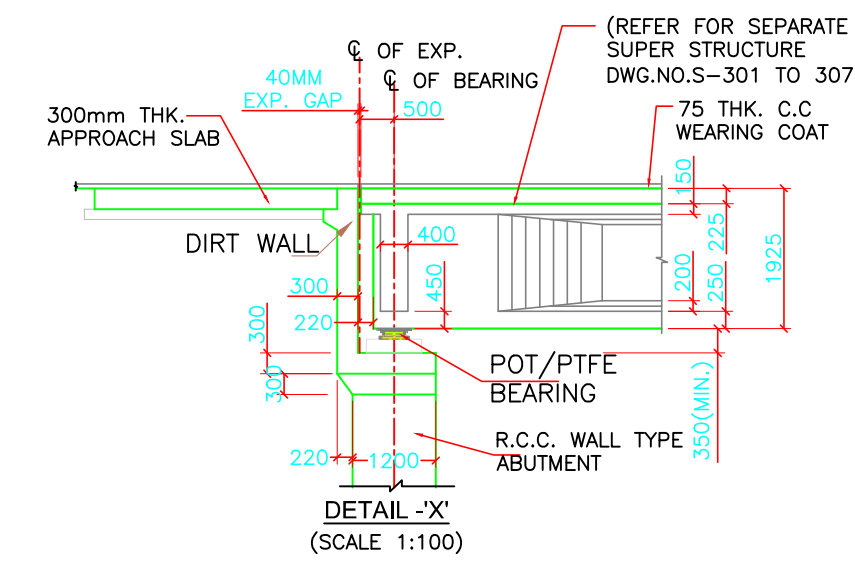
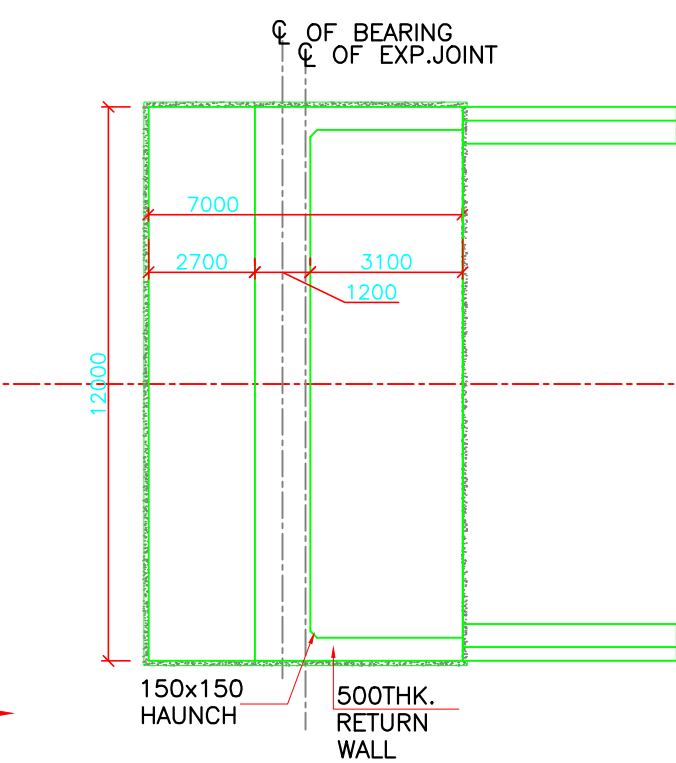
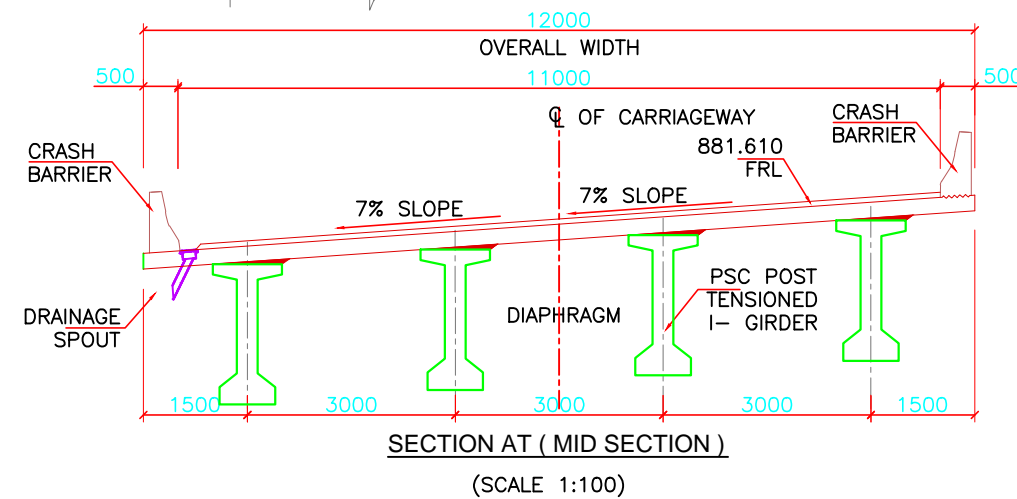
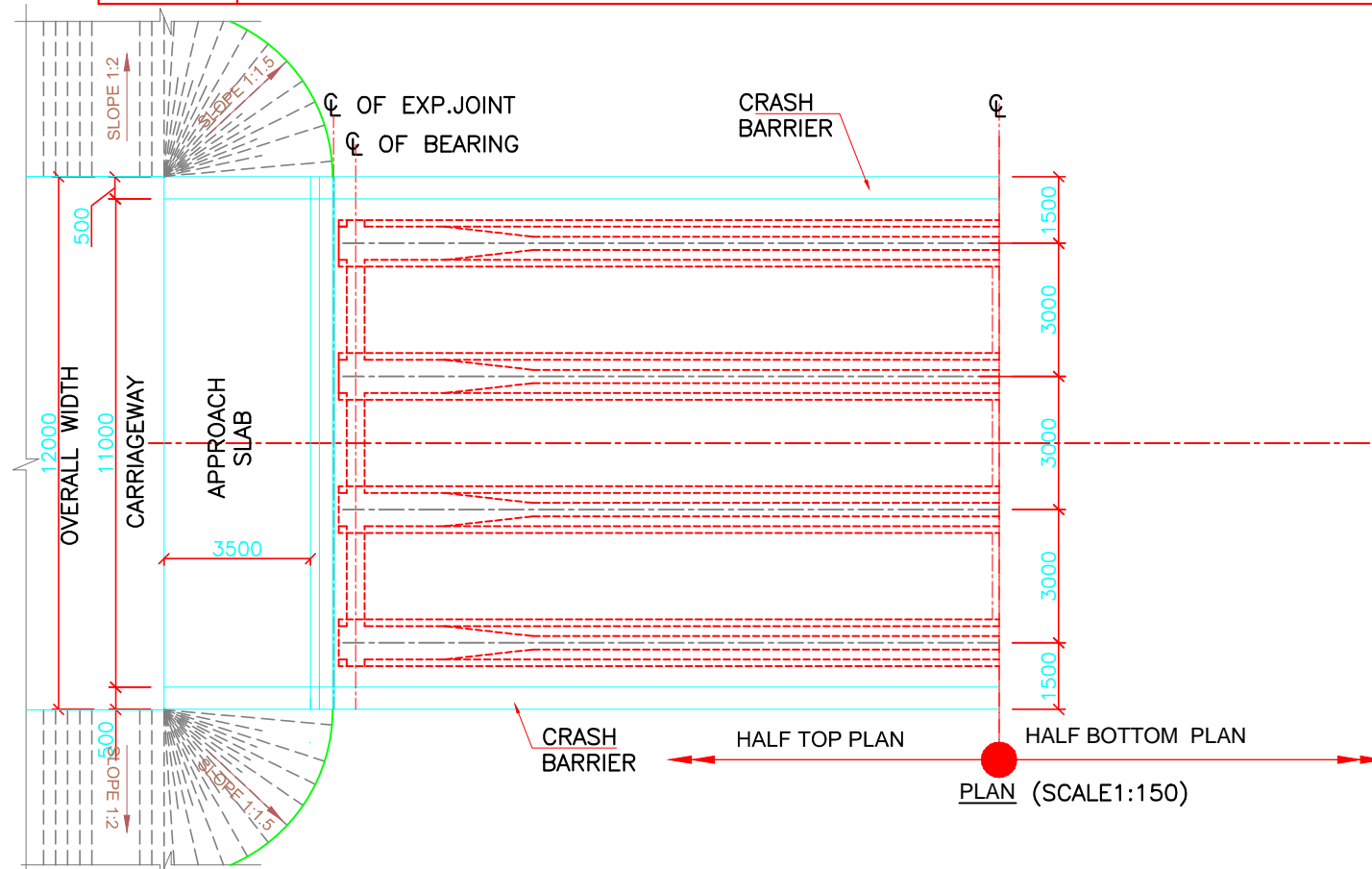

- NOTES :-**
- ALL DIMENSIONS ARE IN MILLIMETERS UNLESS OTHERWISE MENTIONED. ONLY WRITTEN DIMENSIONS SHALL BE FOLLOWED.
 - THIS DRAWING SHALL BE READ IN CONJUNCTION WITH ALL OTHER DRAWINGS.
 - PROPOSED BRIDGE IS DESIGNED FOR 3 LANE OF CLASS A, OR SINGLE LANE OF 70R OF +1 LANE CLASS A WHICHEVER GOVERNS.
 - ALL DIMENSIONS ARE TENTATIVE SUBJECT TO CHANGE DURING DETAILED DESIGN
 - GRADE OF CONCRETE FOR VARIOUS STRUCTURES SHALL BE AS FOLLOWS -
P.C.C. LEVELLING COURSE = M15
SUPERSTRUCTURE = M40
SUBSTRUCTURE = M35
APPROACH SLAB = M30
RETURN/WING WALLS = M35
CRASH BARRIER = M40
 - GRADE OF STEEL- Fe 500 CONFORMING TO IS:1786-1985.
 - THE SELECTED EARTH FILL BEHIND ABUTMENT SHALL HAVE FOLLOWING PROPERTIES WHICH HAVE BEEN ASSUMED FOR DESIGN OF ABUTMENTS FOUNDATION, PARAMETERS $\phi=30^\circ$, γ dry = 18 kN/m AS PER IRC.78
 - 100 DIA. WEED HOLES ARE TO BE PROVIDED @1000 C/C IN STAGGERED MANNER (BOTH HORIZONTALLY & VERTICALLY) IN 1:20 SLOPE
 - (i) CLEAR COVER TO OUTER MOST STEEL IS 50mm FOR ALL COMPONENTS EXCEPT FOUNDATIONS.
(ii) CLEAR COVER TO OUTER MOST STEEL IS 75mm FOR FOUNDATION.
 - EXPANSION JOINT SHALL BE TYPE:- STRIP SEAL
 - PROTECTION WORK SHALL BE PROVIDED AS PER IRC 89:1977.
 - IT MAY BE ENSURED THAT MINIMUM EMBEDMENT OF FOUNDATION IS 1.5M IN SOFT ROCK OR 0.6M IN HARD ROCK AS PER PROVISION OF OR IRC 78.

CLIENT:-



National Highways and Infrastructure
Development Corporation

PROJECT TITLE :-

CONSTRUCTION & UPGRADEATION OF EXISTING ROAD TO 2-LANE WITH PAVED SHOULDERS FROM KM 399.000 TO KM 430.000 OF KARANPRAYAG TO CHAMOLI (EXCLUDING KM 420.250 TO KM 420.500 AND KM 423.300 TO KM 423.650) OF NH-07 UNDER CHARDHAM PARIYOJANA ON EPC BASICS IN THE STATE OF UTTARAKHAND (PKG-II)

REV	DATE	DESCRIPTION	SIGN
R1	JAN.2017	CARRIAGEWAY REVISED	Y.P.S
R2	JAN.2017	GAD REVISED	D.N

TITLE :-

GENERAL ARRANGEMENT DRAWING
1X30M AT (CH.410+390)

DWG. NO. NHIDCL/NH-07/MNB/CH.410+390/S-101

DRN:-	DGN:-	CHK:-	DATE:-	SCALE:-	SHEET SIZE
PRAVEEN	P.V.M	V.P.S	JAN. 2018	AS SHOWN	A2
					SHEET NO:- 01 OF 01

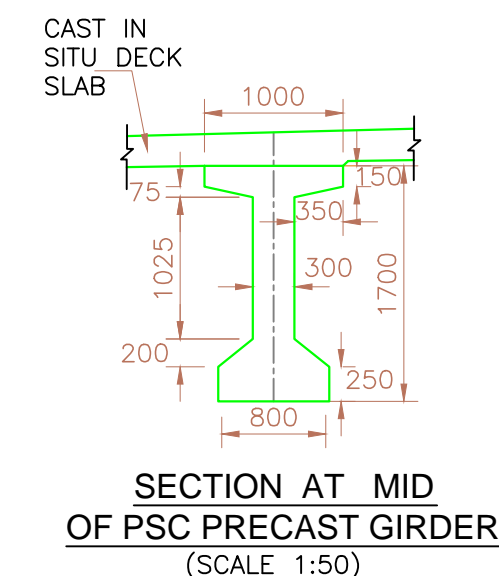
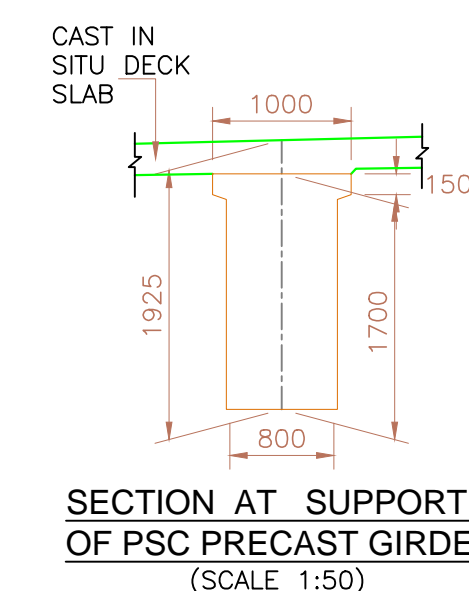
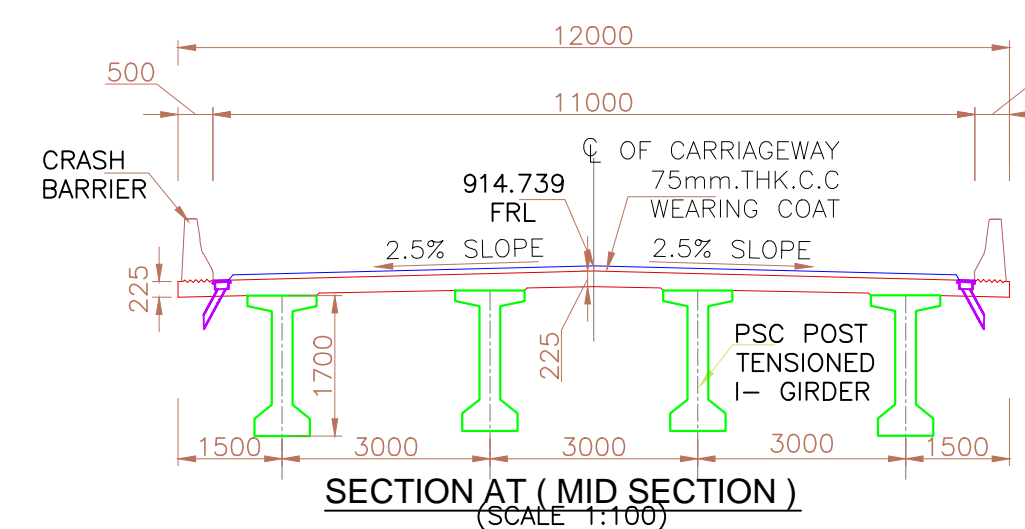
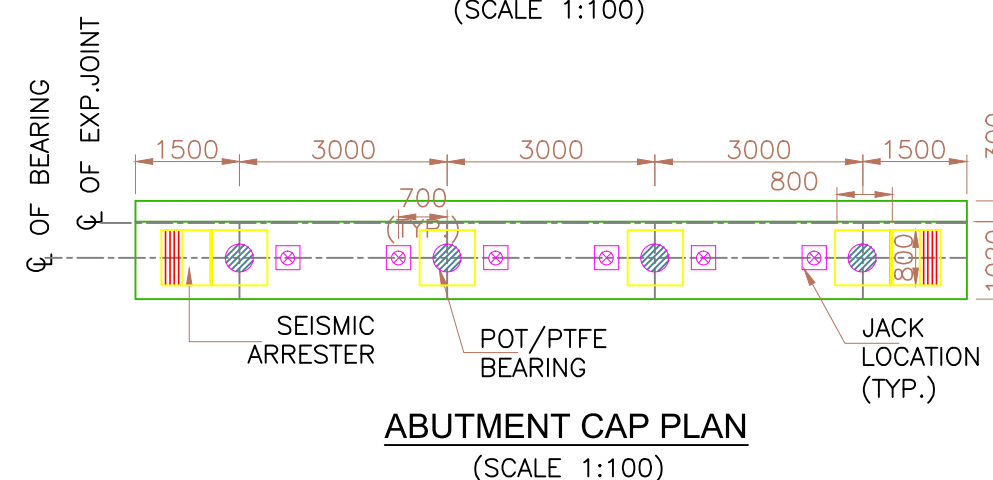
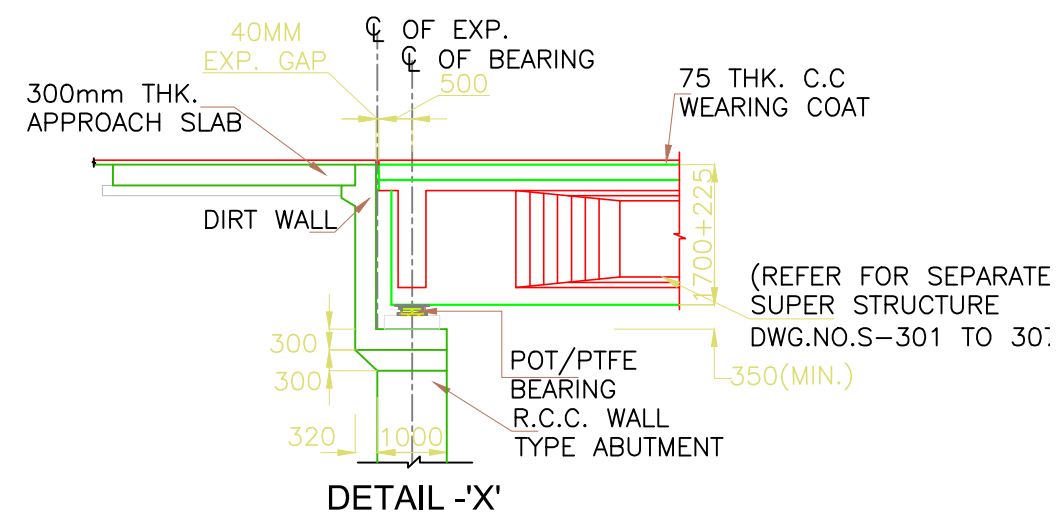
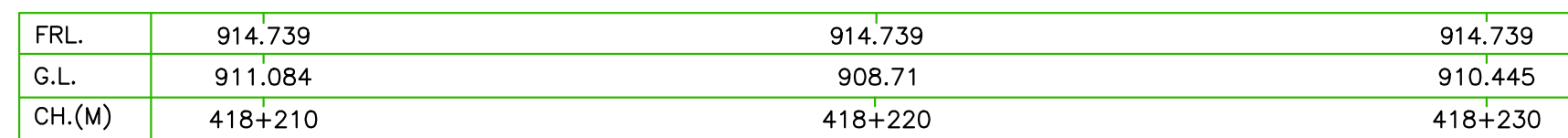

- NOTES :-**
1. ALL DIMENSIONS ARE IN MILLIMETERS UNLESS OTHERWISE MENTIONED. ONLY WRITTEN DIMENSIONS SHALL BE FOLLOWED.
 2. THIS DRAWING SHALL BE READ IN CONJUNCTION WITH ALL OTHER DRAWINGS.
 3. PROPOSED BRIDGE IS DESIGNED FOR 3 LANE OF CLASS A, OR SINGLE LANE OF 70R OF +1 LANE CLASS A WHICHEVER GOVERNS.
 4. GRADE OF CONCRETE FOR VARIOUS STRUCTURES SHALL BE AS FOLLOWS –

P.C.C. LEVELLING COURSE	= M15
SUPERSTRUCTURE	= M45
SUBSTRUCTURE	= M35
APPROACH SLAB	= M30
RETURN/WING WALLS	= M35
CRASH BARRIER	= M40
 5. GRADE OF STEEL– Fe 500 CONFORMING TO IS:1786–1985.
 6. THE SELECTED EARTH FILL BEHIND ABUTMENT SHALL HAVE FOLLOWING PROPERTIES WHICH HAVE BEEN ASSUMED FOR DESIGN OF ABUTMENTS FOUNDATION, PARAMETERS $\phi=30^\circ$, γ dry = 18 kN/m³ AS PER IRC.78
 7. 100 DIA. WEEP HOLES ARE TO BE PROVIDED @1000 C/C IN STAGGERED MANNER (BOTH HORIZONTALLY & VERTICALLY) IN 1:20 SLOPE
 - 8.(i) CLEAR COVER TO OUTER MOST STEEL IS 50mm FOR ALL COMPONENTS EXCEPT FOUNDATIONS.
(ii) CLEAR COVER TO OUTER MOST STEEL IS 75mm FOR FOUNDATION.
 10. EXPANSION JOINT SHALL BE TYPE:- STRIP SEAL
 11. PROTECTION WORK SHALL BE PROVIDED AS PER IRC 89:1977.
 12. IT MAY BE ENSURED THAT MINIMUM EMBEDMENT OF FOUNDATION IS 1.5M IN SOFT ROCK OR 0.6M IN HARD ROCK AS PER PROVISION OF OR IRC 78.

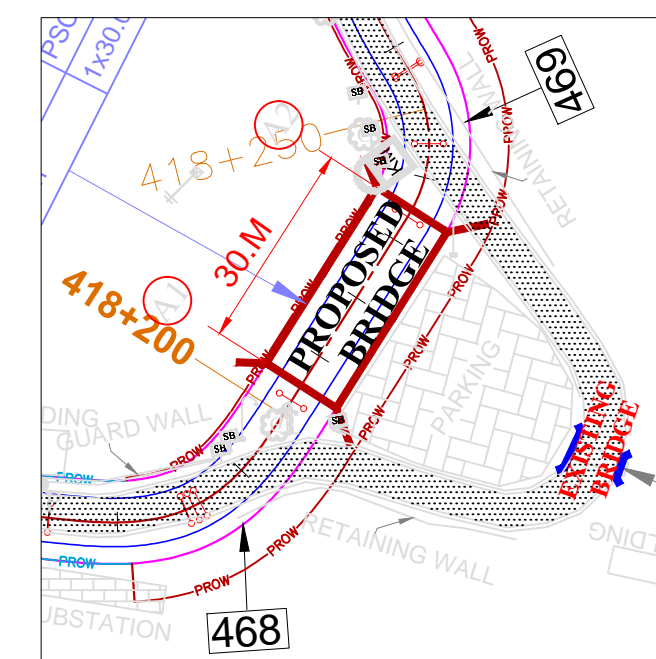

KEY PLAN	
FOR PLANNING	<input type="checkbox"/>
FOR APPROVAL	<input checked="" type="checkbox"/>
FOR CONSTRUCTION	<input type="checkbox"/>
AS BUILT	<input type="checkbox"/>

CLIENT:-

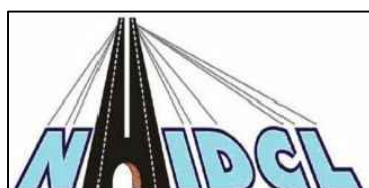

National Highways and Infrastructure
Development Corporation

PROJECT TITLE :-

CONSTRUCTION & UPGRADATION OF EXISTING ROAD TO 2-LANE WITH PAVED SHOULDERS FROM KM 399.000 TO KM 430.000 OF KARANPRAYAG TO CHAMOLI (EXCLUDING KM 420.250 TO KM 420.500 AND KM 423.300 TO KM 423.650) OF NH-07 UNDER CHARDHAM PARIYOJNA ON EPC BASICS IN THE STATE OF UTTRAKHAND (PKG-II)

REV	DATE	DESCRIPTION	SIGNATURE
R1	JAN.2017	CARRIAGEWAY REVISED	Y.P.
R2	JAN.2017	GAD REVISED	D.N.

TITLE :-

GENERAL ARRANGEMENT DRAWING
1X30M AT (CH.418+220)

DWG. NO. NHIDCL /NH-07 /MNB /CH.425+600/S-101

DRN:-	DGN:-	CHK.-	DATE:-	SCALE:-	SHEET SIZE:-
Y.P.S	P.V.M	V.P.S	JAN 2018	AS SHOWN	A2
					SHEET NO:-
					01 OF 01

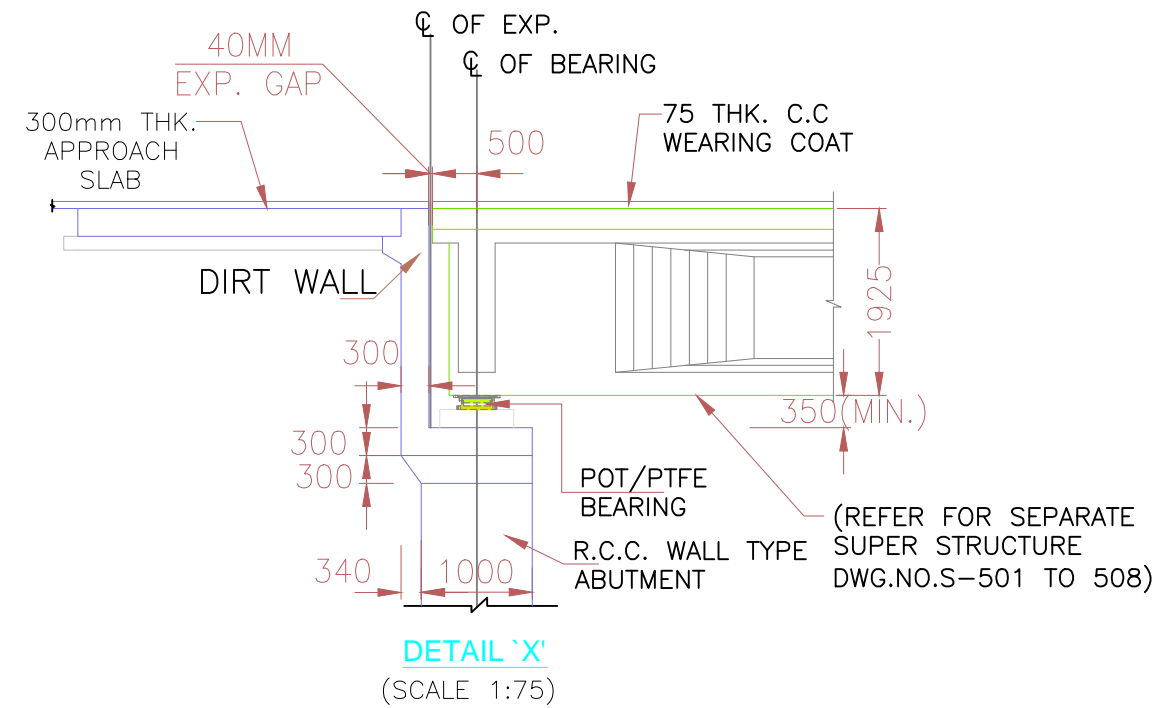
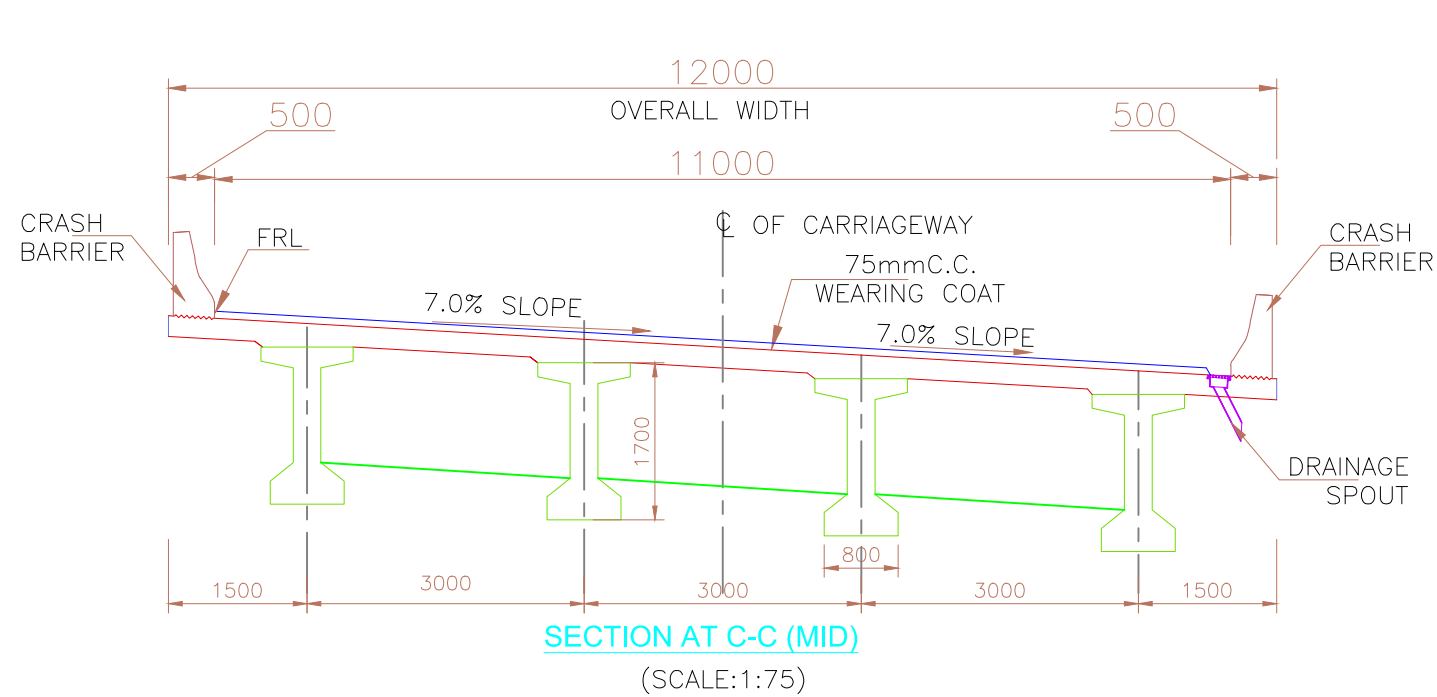

NOTES :-

1. ALL DIMENSIONS ARE IN MILLIMETERS UNLESS OTHERWISE MENTIONED. ONLY WRITTEN DIMENSIONS SHALL BE FOLLOWED.
2. THIS DRAWING SHALL BE READ IN CONJUNCTION WITH ALL OTHER DRAWINGS.
3. PROPOSED BRIDGE IS DESIGNED FOR 3 LANE OF CLASS A, OR SINGLE LANE OF 70R OF +1 LANE CLASS A WHICHEVER GOVERNS.
4. ALL DIMENSIONS ARE TANTATIVE SUBJECTED TO CHANGE DURING DETAILED DESIGN
5. GRADE OF CONCRETE FOR VARIOUS STRUCTURES SHALL BE AS FOLLOWS –
 P.C.C. LEVELLING COURSE = M15
 SUPERSTRUCTURE = M45
 SUBSTRUCTURE = M35
 APPROACH SLAB = M30
 RETAINING WALLS = M30
 CRASH BARRIER = M40
6. GRADE OF STEEL– Fe 500D CONFORMING TO IS:1786–1985.
7. THE SELECTED EARTH FILL BEHIND ABUTMENT SHALL HAVE FOLLOWING PROPERTIES WHICH HAVE BEEN ASSUMED FOR DESIGN OF ABUTMENTS FOUNDATION, PARAMETERS $\phi=30^\circ$, $\gamma_{dry} = 18 \text{ kN/m}^3$ AS PER IRC.78
8. 100 DIA. WEEP HOLES ARE TO BE PROVIDED @1000 C/C IN STAGGERED MANNER (BOTH HORIZONTALLY & VERTICALLY) IN 1:20 SLOPE
- 9.(i) CLEAR COVER TO OUTER MOST STEEL IS 50mm FOR ALL COMPONENTS EXCEPT FOUNDATIONS.
 (ii) CLEAR COVER TO OUTER MOST STEEL IS 75mm FOR FOUNDATION.
10. EXPANSION JOINT SHALL BE TYPE:- STRIP SEAL
11. PROTECTION WORK SHALL BE PROVIDED AS PER IRC 89:1977.
12. IT MAY BE ENSURED THAT MINIMUM EMBEDMENT OF FOUNDATION IS 1.5M IN SOFT ROCK OR 0.6M IN HARD ROCK AS PER PROVISION OF OR IRC 78.

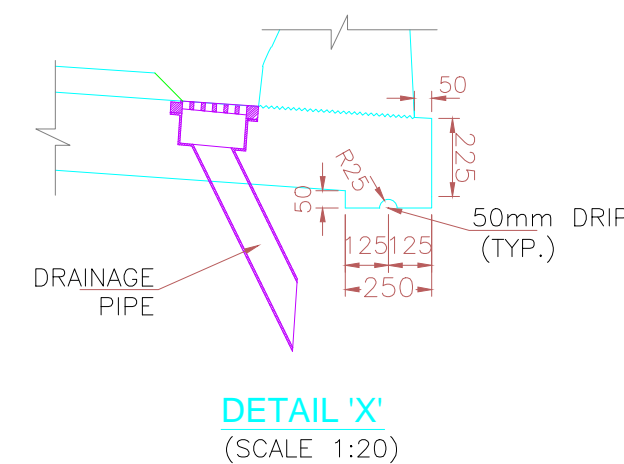
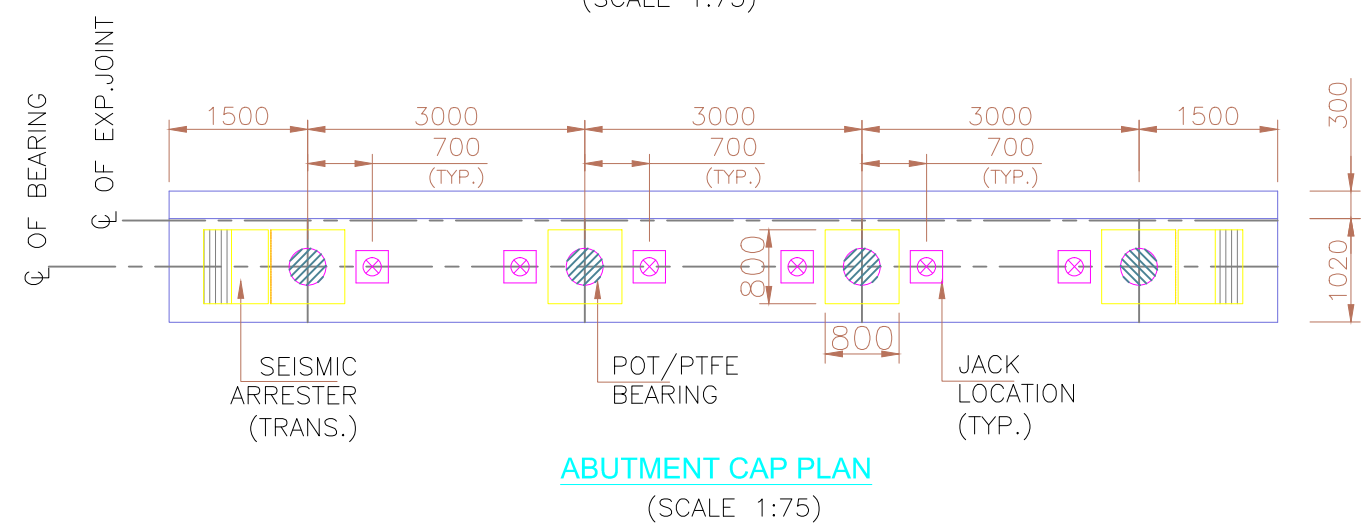
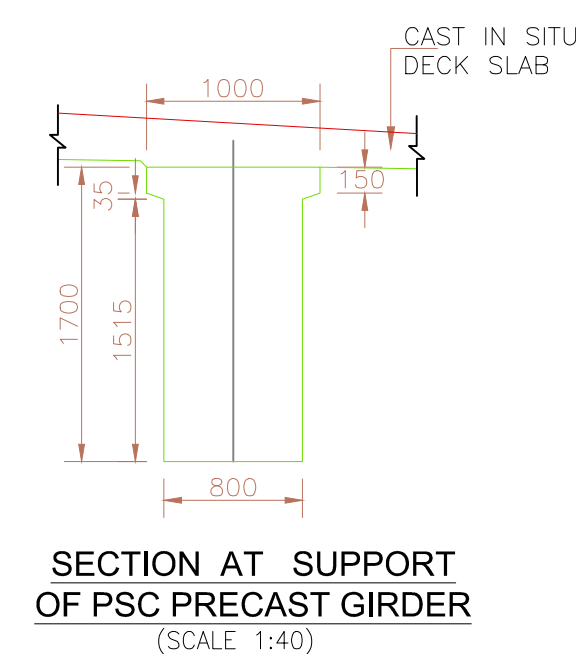
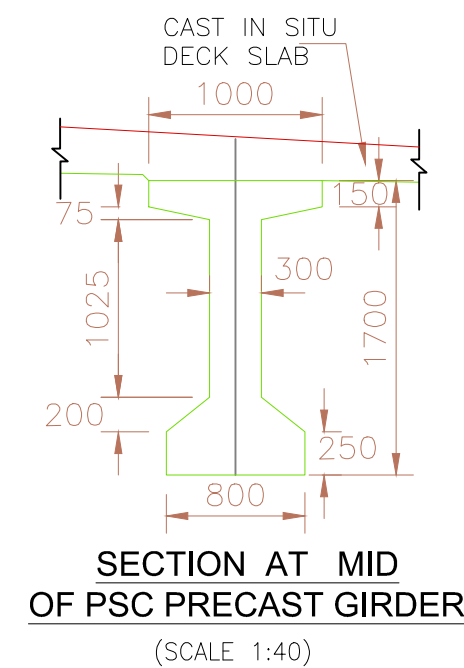
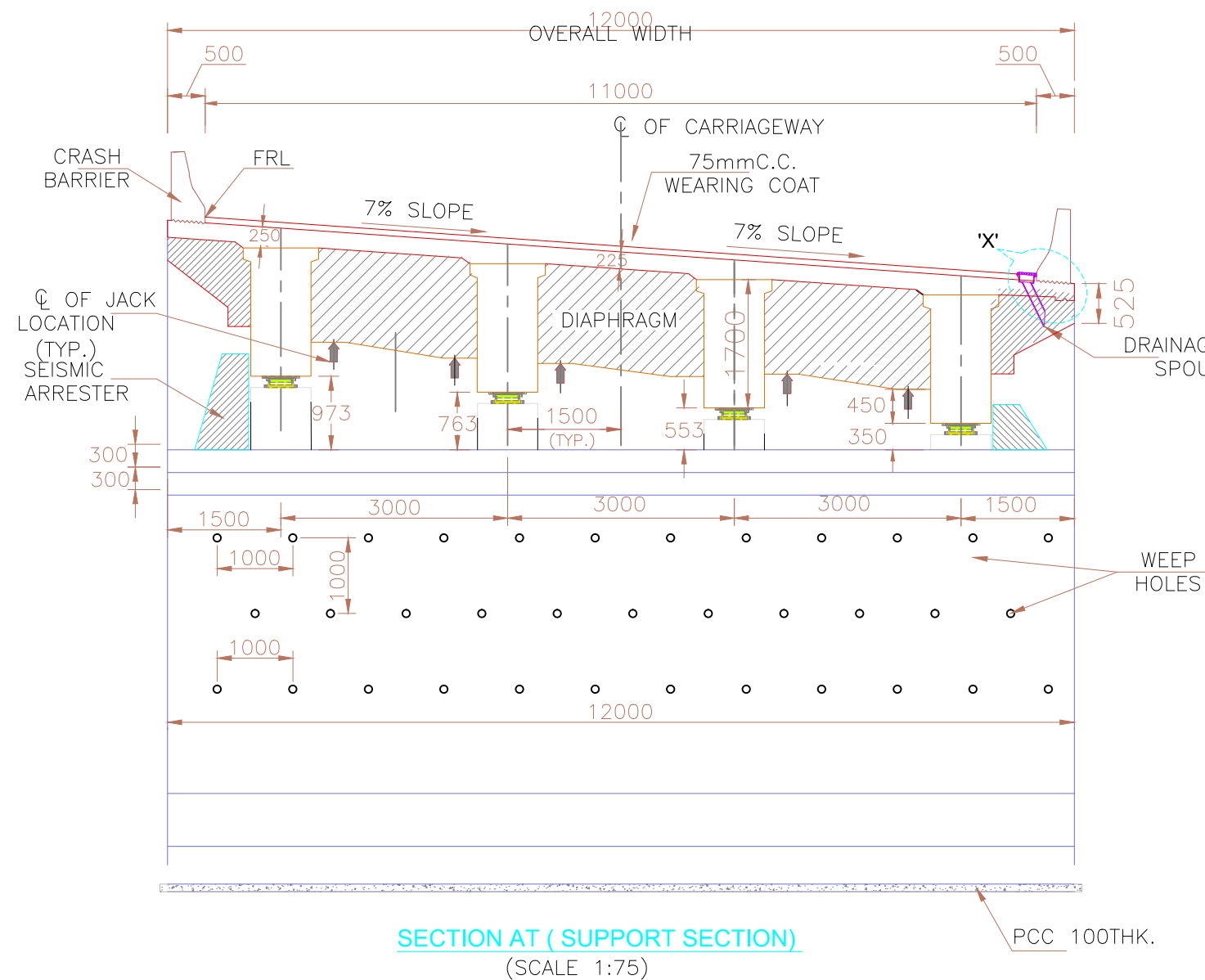

CLIENT:-

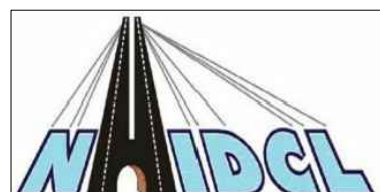

**National Highways and Infrastructure
Development Corporation**

PROJECT TITLE :-

CONSTRUCTION & UPGRADATION OF EXISTING ROAD TO 2-LANE WITH PAVED SHOULDERS FROM KM 399.000 TO KM 430.000 OF KARANPRAYAG TO CHAMOLI (EXCLUDING KM 420.250 TO KM 420.500 AND KM 423.300 TO KM 423.650) OF NH-07 UNDER CHARDHAM PARIYOJNA ON EPC BASICS IN THE STATE OF UTTARAKHAND (PKG-II)

REV	DATE	DESCRIPTION	SIGN
R1	NOV.2016	CARRIAGEWAY REVISED	Y.P.S

TITLE :-

**GENERAL ARRANGEMENT DRAWING
MNB (1X30.0M) AT (CH.419+600)**

DWG. NO. NHIDCL /NH-07 /MNB /CH.419+600/S-101

DRN:-	DGN:-	CHK:-	DATE:-	SCALE:-	SHEET SIZE
Y.P.S	P.V.M	V.P.S	JAN 2018	AS SHOWN	A2
					SHEET NO:-
					02 OF 02